



SECURE YOUR HOME AND BELONGINGS







# COMPANY PROFILE

Since 1995, High Reserve Marketing established the GERE brand with proven standards of reliability and trust. Its product range represents a sophisticated composition of mechanical ingenuity and cutting-edge design innovation.

Prestigiously reputed as the ultimate lock and hardware maker, each product in this catalogue is highly reflective of GERE's brand mission. The brand mission is to provide you with superior manufacturing excellence and premium product quality.

GERE, a brand name well ingrained within the architectural imprint that have carved the path towards GERE INTERNATIONAL. It has been making waves in the overseas export market to South America and planning to expand to other countries worldwide.

GERE product range such as the well-built padlocks are well recognised by the United Kingdom Accreditation Service (UKAS) under the BS EN 12320:2012, UK Standard, CEN European Standard BS EN 12320:2012 and TUV BS EN ISO9227:2007, BS EN 1670:2007, INTERTEK BS EN 1670:2007/2009/AC. GERE products has obtained ANSI BHMA 156.2 from SIRIM QAS International, a rare public endorsement by an independent certification agency for a Malaysia brand.





# NEXT LEVEL OF HOME SECURITY

GERE's superior and innovative product range have achieved many certifications from SIRIM QAS International and other certification bodies:

YEAR	PRODUCT	STANDARD	CERTIFICATION
2007	GERE Padlock CL939 & CL99	BS EN 12320:2001	UKAS
2010	GERE Cylindrical Knobset, Tubular Knobset	ANSI/BHMA A 156.2:2003	SIRIM QAS International
2010	GERE Mortise Lock	ANSI/BHMA A 156.13:2005	SIRIM QAS International
2010	GERE Handle Set & DeadBolt	ANSI/BHMA A 156.5:2001	SIRIM QAS International
2012	GERE Padlock	BS EN ISO9227:2007 BS EN 1670:2007	Technischer Überwachungsverein (TUV)
2013	GERE Padlock	BS EN 12320:2012	SIRIM QAS International
2013	GERE Padlock	BS EN 1670:2007/2009/AC	INTERTEK
2013	GERE Mortise Lock	BS EN 12209:2003	SIRIM QAS International (Fire Rated Door Compliance)
2013	GERE Hinge	BS EN 1935:2002	SIRIM QAS International (Fire Rated Door Compliance)
2015	GERE Door Closer	BS EN 1154:1997	SIRIM QAS International (Fire Rated Door Compliance)
2015	GERE Floor Spring	BS EN 1154:1997	SIRIM QAS International (Fire Rated Door Compliance)
2015	GERE Padlock	BS EN 12320:2012	UKAS

GERE Padlock is the first and the only padlock in Malaysia to achieve SIRIM QAS International's certification in year 2013.

In year 2013, High Reserve Marketing and GERE have also attained the prestigious Keris Award (Asia Pacific International Honesty Enterprise and Honesty Product) respectively

As for the Fire Rated Door, GEREdor has attained the 60 minutes Single Leaf Composite Fire Resistant Door with EG Steel Door Frame. Tested by SIRIM QAS International Sdn. Bhd. Under MS 1073:Part 3:1996 with latest (Amd.1:2003) Specification for Fire Resistant Doorset in year 2015.

Being the pioneer in this industry, it is GERE's vision to have that unyielding mission to continuous pursue the latest in design and material innovative advancement in order to continually evolve its product range to new heights of distinction.

Our main mission is our customers. GERE's brand mission is upholding our customers' continual trust and unwavering support.

To enquire more about us and GERE products and its large range of the latest products offerings, please log in to [www.gere-products.com](http://www.gere-products.com).

# CYLINDERS - KEY SYSTEMS

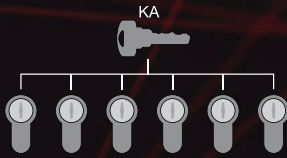

## KEY ALIKE SYSTEM

KA

All the cylinders have the same differ and be opened only by one key.

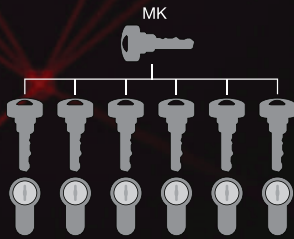

## MASTER KEY SYSTEM

MK

Every cylinder can be opened by its own key which cannot open any other cylinder of the system. All the cylinders can be opened by MK management key.

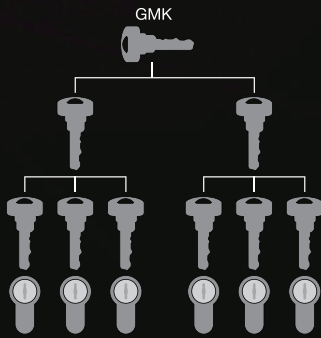

## GRAND MASTER KEY SYSTEM

GMK

Same as the management key system but in two or more groups. Every group of cylinders can be opened by its own service key. All the cylinders of the system can be opened by the GMK grand management key.

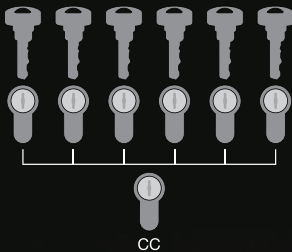

## CENTRAL CYLINDER SYSTEM

CC

Every cylinder has its own key which cannot open any other cylinder of the system. All the keys of the system can open the cylinder of the central lock.

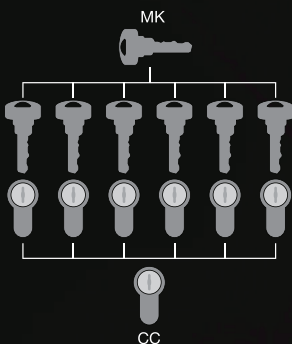

## CENTRAL CYLINDER SYSTEM AND MASTER KEY

CCMK

Every cylinder has its own key which cannot open any other cylinder of the system, except the central system. All the cylinders of the system can be opened by the MK management key.



## CONSTRUCTION KEYED SYSTEM

CMK

A system where it is necessary for contractors to gain entry to a building during construction but to prevent entry by the same contractors after the building has been occupied or handed over. The system makes it possible to change from construction keying to normal keying.



# CONTENTS

---

	PAGE
SMART LOCK	5
FIRE DOOR	8
TUBULAR GRIP SET	13
MORTISE LEVER WITH FACEPLATE	16
SUS 304 LEVER HANDLE	22
MORTISE LOCKCASE	25
PROFILE CYLINDER	28
TUBULAR LEVER	29
CYLINDRICAL DOOR KNOB	32
PADLOCK	37
DOOR CLOSER	44
FLOOR SPRING SERIES	49
PULL HANDLE   HINGES   DOOR TRACK	53
ACCESSORIES	59
PANIC EXIT DEVICE	71
EUROPLUS   PROPILOT	74
KEY BLANK	76



 WIRELESS  
(BLUETOOTH & WIFI)

 APP CONTROL

 FINGER PRINT

 PIN CODE

 CARD

 SCREEN DISPLAY  
INDICATOR

 VOICE GUIDE

 MECHANICAL KEY

 USB EMERGENCY  
CHARGING



# SMART LOCK

 **GERE**<sup>®</sup>  
Symbol of Quality



EN 14846:2008

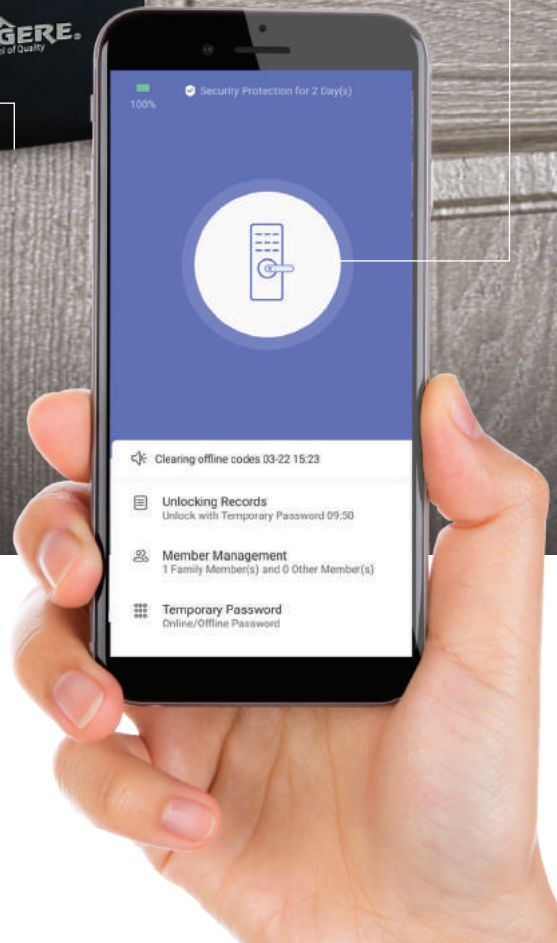



# Smart Lock G-H1900 Series



1 G-H1901 • 2 G-H1901-2 • 3 G-H1901-3 • 4 G-H1902-D11 • 5 G-H1902-D12 • 6 G-H1903-K1 • 7 G-H1904-K80

Model	1	2	3	4	5	6	7
Wireless (bluetooth/wifi by app control)	✓	✓	✓	✓	✓	✓	✓
Finger print		✓	✓	✓	✓	✓	✓
Pin code, key card, mechanical key	✓	✓	✓	✓	✓	✓	✓
Up to 300 users (combination of passcode/card/finger print)	✓	✓	✓	✓	✓	✓	✓
Usb emergency charging	✓	✓	✓	✓	✓	✓	✓
Unlock records (500 data)	✓	✓	✓	✓	✓	✓	✓
Temporary passcode function	✓	✓	✓	✓	✓	✓	✓
Passage function	✓	✓	✓				
Dual verification function	✓	✓	✓	✓	✓	✓	✓
Fake code function	✓	✓	✓	✓	✓	✓	✓
Ultra thin panel (13mm)	✓	✓	✓				
Camera & digital door viewer function						✓	
Sus304 stainless steel panel	✓	✓	✓				
Water resistance	✓	✓	✓	✓	✓	✓	✓
Grade 3 security (100,000 cycles test)	✓	✓	✓	✓	✓	✓	✓



EN 14846:2008

Model

## G-H1901

Smart Lock



Diagram

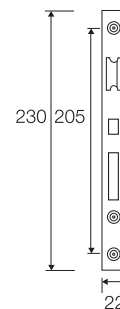
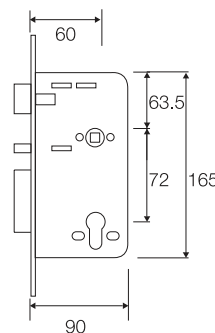
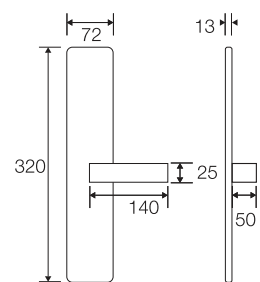



# Smart Lock G-H1900 Series

Model

## G-H1902-D11 / G-H1902-D12

Smart Lock



Diagram

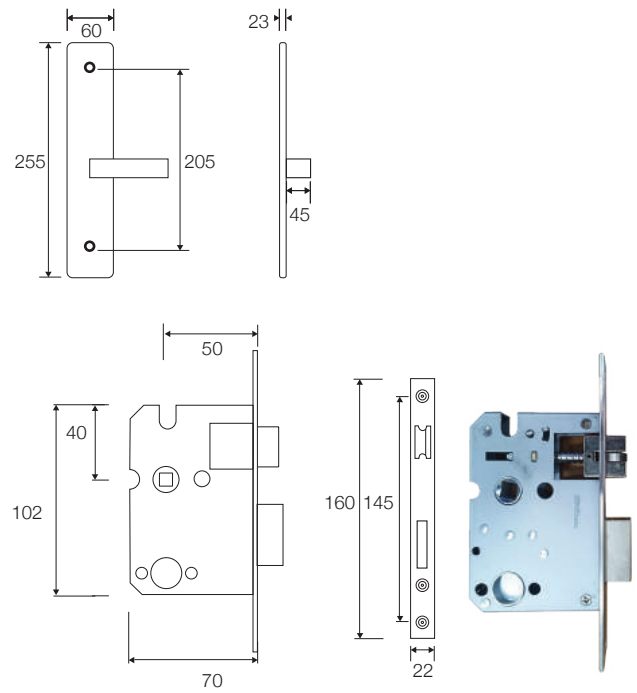

Model

## G-H1903-K1

Smart Lock



Model

## G-H1904-K80

Smart Lock



Diagram

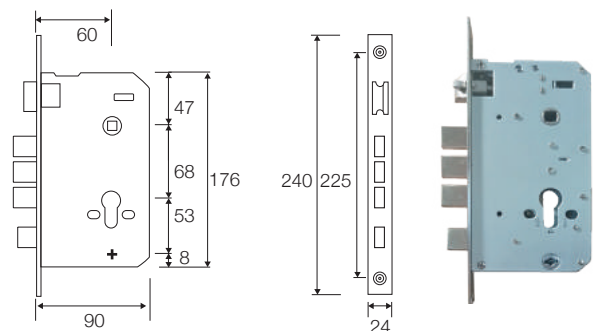
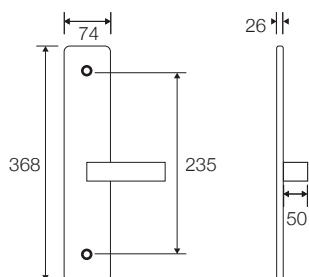





# FIRE RATED DOOR

 **GEREdor**<sup>®</sup>  
Symbol of Quality

Certified by:   
SIRIM

CERTIFIED TO: ANSI/BHMA A 156.13:2005  
Certification No: PC000360

Approved by: 

## QUALITY FIRE-RATED DOOR

**GEREdor** specialises in Fire Rated Doors that meet the needs of our clients. **GEREdor** Fire Rated Doors come in various styles and configurations to meet the needs of both residential and commercial projects. **GEREdor** has been tested by Sirim QAS International Malaysia which has been approved by Jabatan Bomba dan Penyelamatan Malaysia.

- 1 HOUR RATED FIRE RESISTANCE
- BS EN 12209:2003 STANDARD AND ANSI/ BHMA A 156.13:2005 COMPLIANCE IRONMONGERIES
- TESTED AND IN COMPLIANCE TO MS 1073: PART 3: 1996 (AMD. 1: 2003)
- ELECTRO GALVANISED METAL DOOR FRAME
- SINGLE / DOUBLE PROFILE FRAME

### TYPICAL DOOR JAMB SECTION



Diagram

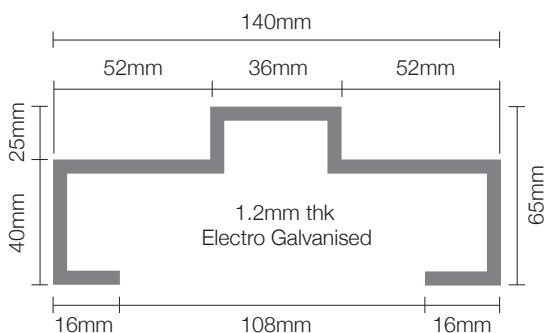

### CROSS SECTION OF DOOR LEAF

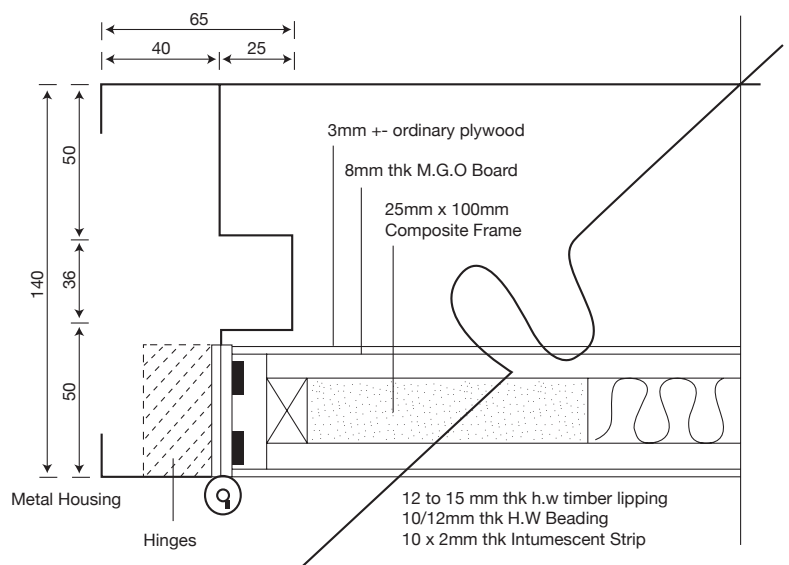





**HOW TO DIFFERENTIATE AND IDENTIFY LEFT OR RIGHT FOR METAL FRAME**

**SINGLE LEAF DOOR**

**ALWAYS PULL TO OPEN THE DOOR**



**Right Hand Frame**

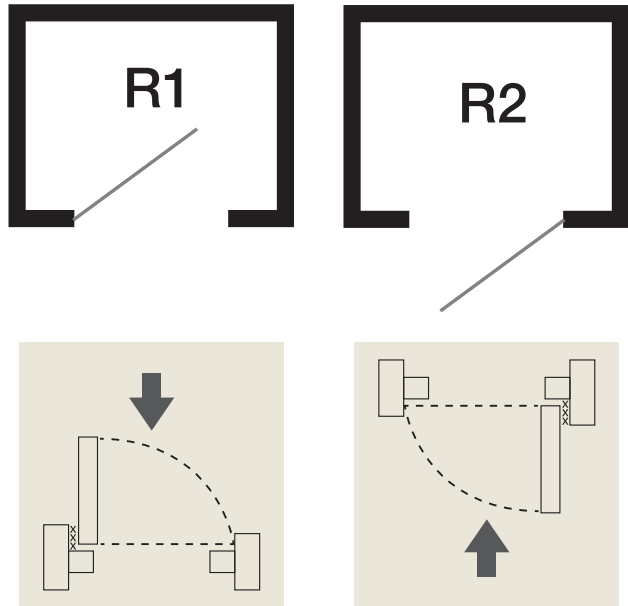

**Left Hand Frame**

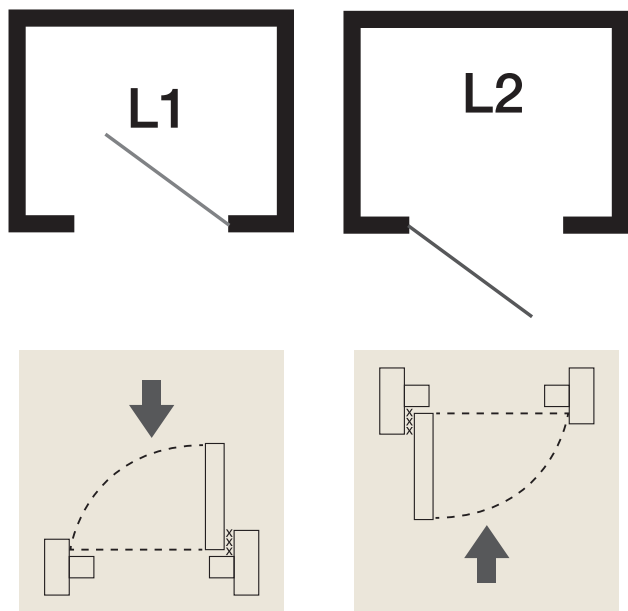

**SINGLE LEAF ONE HOUR FIRE RATED DOOR WITH ELECTRO GALVANIZED METAL DOOR FRAME**

**Maximum Size 1200mm x 2400mm**  
**Model : GEREdor MFKL/SL/1H/8MM/GERE**

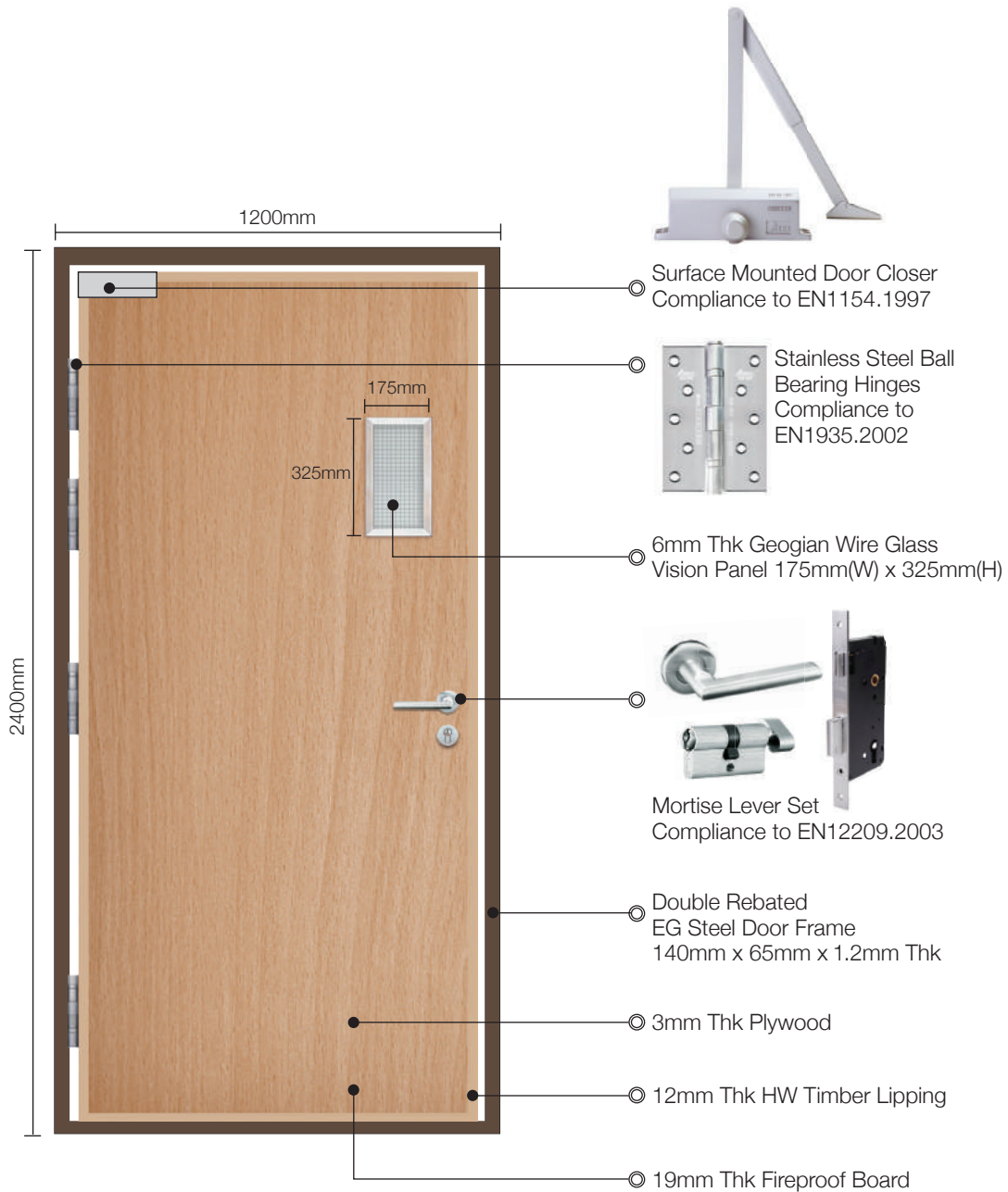

CERTIFIED TO: BS EN 1154:1997  
 Certification No: PC001791



CERTIFIED TO: ANSI/BHMA A 156.13:2005  
 Certification No: PC000360







**DOUBLE LEAF ONE HOUR FIRE RATED DOOR WITH ELECTRO GALVANIZED METAL DOOR FRAME**

**Maximum Size 2400mm x 2400mm**  
**Model : GEREdor DL/1HR/8MM/MF**

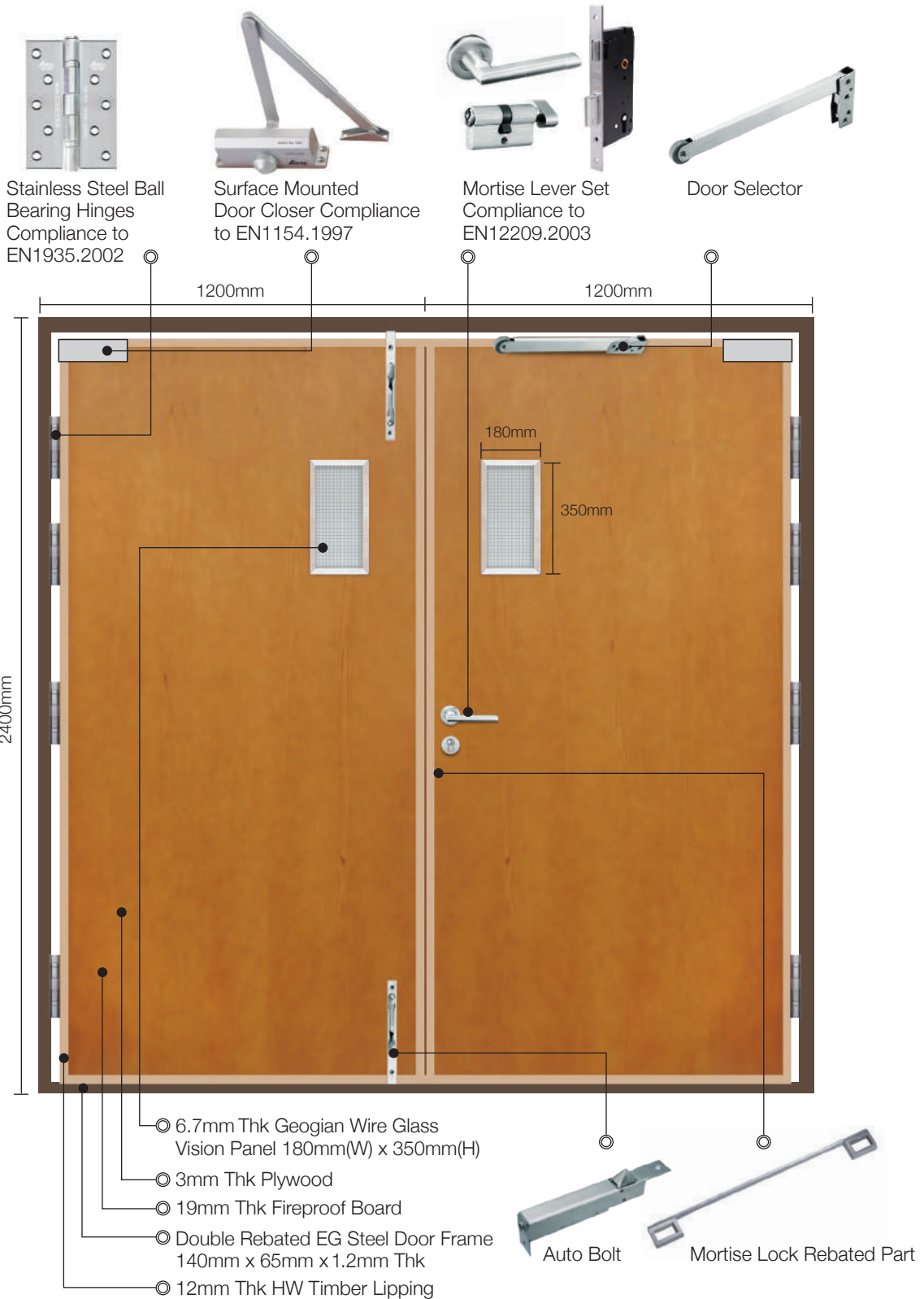



# TUBULAR FUNCTION HANDLE SET



SIRM  
CERTIFIED TO: ANSI/BHMA A 156.2:2003  
Certification No: PC000359



# Tubular Grip Set



## Finishing

- M26D** - Satin Chrome
- M11** - Antique Copper
- M10B** - Matt Black
- M3M** - Satin Gold
- M28** - Dark Grey



## Function

- Entrance
- Dummy

## Specification

- One locking system
- 60mm - 70mm adjustable backset
- Suitable door thickness 32mm - 45mm
- 3 Brass key
- Zink alloy body
- Solid brass core cylinder

## Feature

- Sirim Approval
- Grade 3 security
- 200,000 cycles test
- All Weather



CERTIFIED TO: ANSI/BHMA A 156.2:2003  
Certification No: PC000359

## Diagram

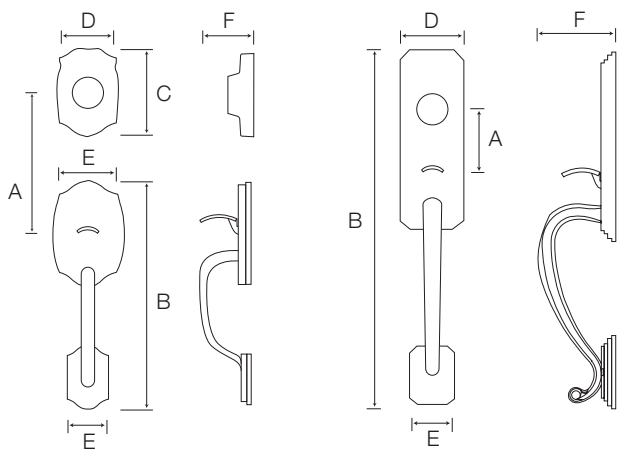

## Installation

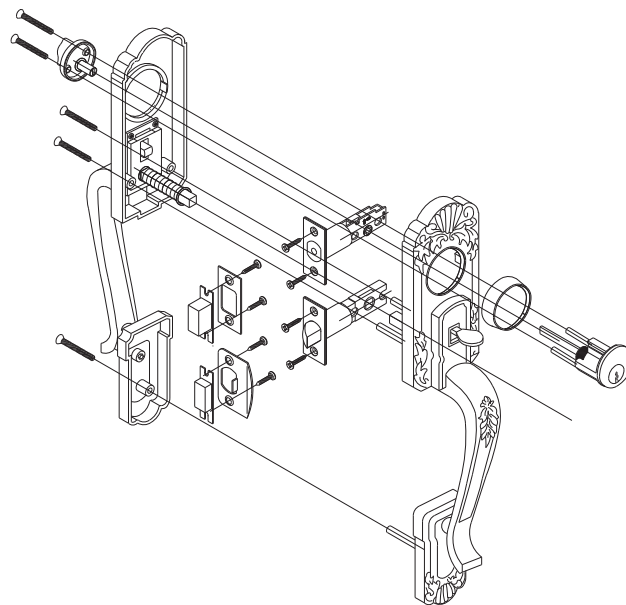

Stock Code	Size	A	B	C	D	E	F	Packing	Weight (KG)	M26D	M10B	M3M	M11	M28
G26681		135	300	100	65	45	65	6	12.5		✓		✓	✓
G26821		135	300	100	65	50	55	6	12.5		✓		✓	✓
G28051		135	260	80	57	40	60	12	13	✓	✓	✓	✓	✓
G28061		135	260	80	57	41	60	12	13		✓	✓	✓	✓
G28071		135	300	80	57	40	60	6	12.5	✓	✓	✓	✓	✓
G28081		70	360	N/A	70	45	60	6	12.5		✓	✓	✓	✓
G28091		70	360	N/A	70	45	60	6	12.5	✓	✓	✓	✓	✓
G270750		214	440	N/A	70	45	65	4	11.5	✓	✓		✓	✓



# Tubular Grip Set

Model  
**G 270750**  
Zinc Alloy Handle set



Model  
**G 28081**



Model  
**G 28091**



Model  
**G 28071**



Model  
**G 26681**



Model  
**G 26821**



Model  
**G 28051**



Model  
**G 28061**







# STAINLESS STEEL MORTISE LEVER HANDLE



CERTIFIED TO: ANSI/BHMA A 156.13:2005  
Certification No: PC000360

# Mortise Lever Handle With Faceplate



## Finishing

**M26D** - Satin Chrome

**M10B** - Matt Black

**M28** - Dark Grey



## Function

- Entrance
- Privacy
- Dummy

## Specification

- One locking system
- Standard backset 60mm
- Suitable door thickness 32mm - 65mm
- 3 Brass key
- Brass Profile Cylinder
- Stainless steel SUS304 body

## Feature

- Sirim Approval
- Grade 3 security
- 200,000 cycles test
- All Weather



CERTIFIED TO: ANSI/BHMA A 156.13:2005  
Certification No: PC000360

## Diagram

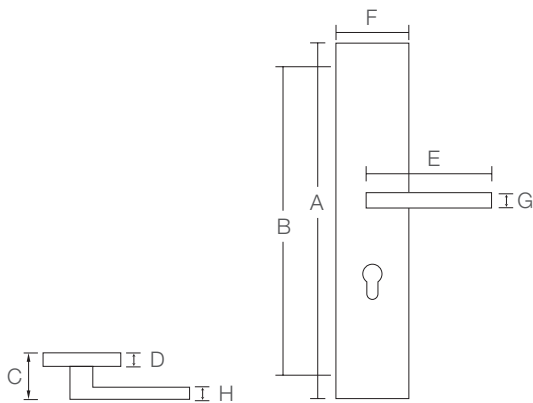

## Installation

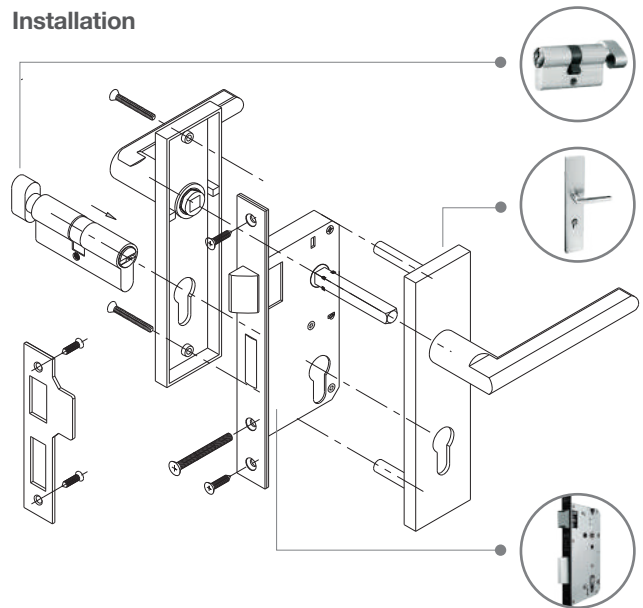

Stock Code	Size	A	B	C	D	E	F	G	H	Packing	Weight (KG)	M26D	M10B	M28
GDL2210-300		300	280	70	15	136	60	22	18	6	12	✓	✓	✓
GDL2220-300		300	280	70	15	134	60	22	15	6	12	✓	✓	✓
GDL2230-300		300	280	70	15	135	60	24	13	6	12	✓	✓	✓
GDL2240-300		300	280	70	15	140	60	22	18	6	12	✓	✓	✓
GDL2250-300		300	280	70	15	134	60	22	15	6	12	✓	✓	✓
GDL3207		320	280	70	15	132	60	12	18	6	12	✓	✓	✓
GDL3211		320	280	70	15	132	60	22	9	6	12	✓	✓	✓
GDL3219		320	280	70	15	132	60	22	12	6	12	✓	✓	✓
GL8413		240	210	65	10	125	50	24	13	12	15	✓	✓	✓
GL8231		280	210	65	10	124	50	18	24	12	15	✓	✓	✓
GL8103		240	210	65	10	116	50	18	24	12	15	✓	✓	✓



# Mortise Lever Handle With Faceplate



Model  
**GDL 2210-300**



Model  
**GDL 2220-300**



Model  
**GDL 2230-300**



Model  
**GDL 2240-300**



Model  
**GDL 2250-300**



Model  
**GDL 3219**



Model  
**GDL 3211**



Model  
**GDL 3207**



Model  
**GL 8413**



Model  
**GL 8231**



Model  
**GL 8103**





# MORTISE FUNCTION LEVER SET



CERTIFIED TO: ANSI/BHMA A 156.13:2005  
Certification No: PC000360



# Mortise Lever With Faceplate



### Finishing

**M26D** - Satin Chrome

**M10B** - Matt Black

**M28** - Dark Grey



### Function

- Entrance
- Dummy

### Specification

- One locking system
- Standard backset 25mm & 45MM
- Suitable door thickness 25mm - 38mm
- 3 Brass key
- Brass Profile Cylinder
- Zinc alloy body

### Feature

- Sirim Approval
- Grade 3 security
- 200,000 cycles test
- All Weather



CERTIFIED TO: ANSI/BHMA A 156.13:2005  
Certification No: PC000360

### Diagram

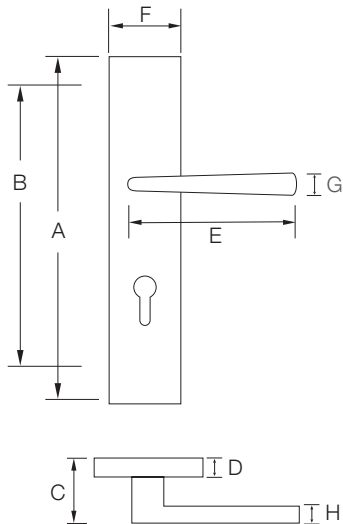

### Mortise Lock Case - G 8811 / G 8821 / G 8831 / G 8841

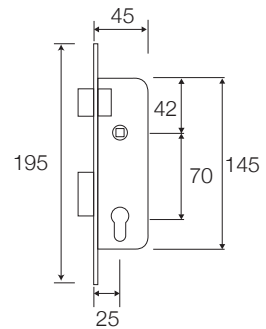

### Mortise Lock Case - GS 7711 / GS 7721 / GS 7731

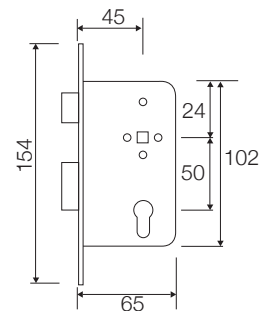

Stock Code	Size	A	B	C	D	E	F	G	H	Packing	Weight (kg)	M26D	M10B	M28
GS7711		165	130	60	12	119	50	22	9	12	17.5	✓	✓	✓
GS7721		165	130	60	12	119	50	22	9	12	17.5	✓	✓	✓
GS7731		165	130	62	12	119	50	12	18	12	17.5	✓	✓	✓
G8811		190	158	37	6	112	27	8	24	24	28	✓	✓	✓
G8821		190	156	37	6	110	25	19	16	24	28	✓	✓	✓
G8831		190	150	37	6	112	30	8	24	24	28	✓	✓	✓
G8841		190	156	37	6	110	25	19	16	24	28	✓	✓	✓



# Mortise Lever With Faceplate

Model  
**G 8811**



Model  
**G 8821**



Model  
**G 8831**



Model  
**G 8841**



Model  
**GS 7711**



Model  
**GS 7721**



Model  
**GS 7731**





# SUS 304 LEVER HANDLE



CERTIFIED TO: ANSI/BHMA A 156.13:2005  
Certification No: PC000360

# SUS 304 Lever Handle



## Finishing

**M26D** - Satin Chrome

**M10B** - Matt Black

**M28** - Dark Grey



## Function

- Entrance
- Dummy

## Specification

- One locking system
- Standard backset 60mm
- Suitable door thickness 32mm - 65mm
- 3 Brass key
- Brass Profile Cylinder

## Feature

- Sirim Approval
- Grade 3 security
- 200,000 cycles test
- All Weather



CERTIFIED TO: ANSI/BHMA A 156.13:2005  
Certification No: PC000360

## Diagram

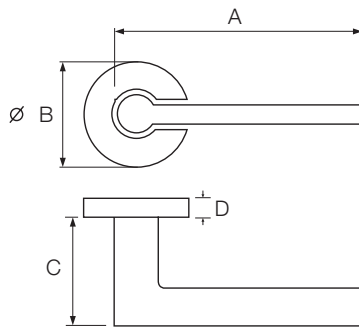

## Installation

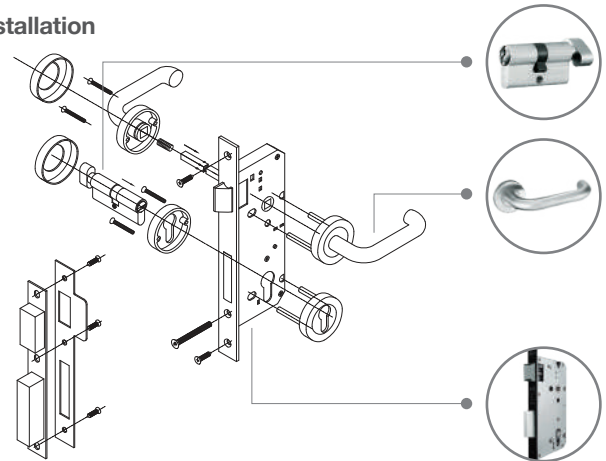

Stock Code	Size	A	B	C	D	Packing	Weight (KG)	M26D	M10B	M28
G001		125	52	60	8.5	20	19.3	✓	✓	✓
G002		129	52	56	8.5	20	19.3	✓	✓	✓
G101		140	52	73.5	8.5	20	11.5	✓	✓	✓
G102		140	52	73.5	8.5	20	11.5	✓	✓	✓
G111		128	52	64.5	8.5	20	11.5	✓	✓	✓
G1001		144	52	66.5	8.5	20	11.5	✓	✓	✓
G1003		140	52	73.5	8.5	20	11.5	✓	✓	✓
G2010		138	52	68.5	8.5	20	12	✓	✓	✓
G2020		134	52	63.5	8.5	20	12	✓	✓	✓
G2030		135	52	73.5	8.5	20	12	✓	✓	✓
G2040		140	52	61.5	8.5	20	12	✓	✓	✓
G2050		134	52	68.5	8.5	20	12	✓	✓	✓
G2060		130	52	65	8.5	20	12	✓	✓	✓
G2070		130	52	65	8.5	20	12	✓	✓	✓
G2100		147	52	24	35	12	12	✓	✓	✓



# SUS 304 Lever Handle



Model  
**G 001**



Model  
**G 002**



Model  
**G 101**



Model  
**G 102**



Model  
**G 111**



Model  
**G 1001**



Model  
**G 1003**



Model  
**G 1003 (Oval)**



Model  
**G 2010**



Model  
**G 2020**



Model  
**G 2030**



Model  
**G 2040**



Model  
**G 2050**



Model  
**G 2060**



Model  
**G 2070**



Model  
**G 2100**



# MORTISE LOCKCASE

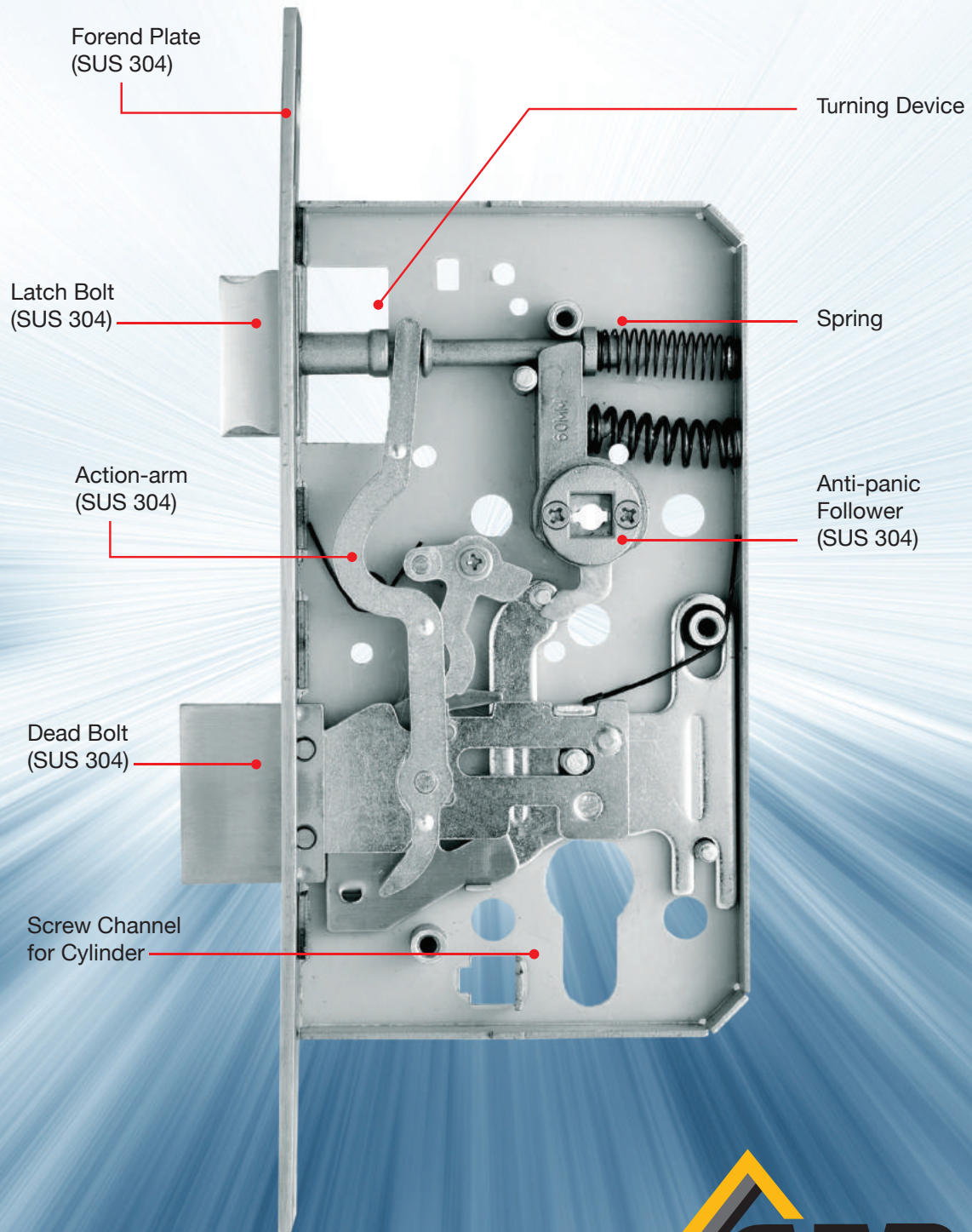

# Mortise Lock Function



## Diagram

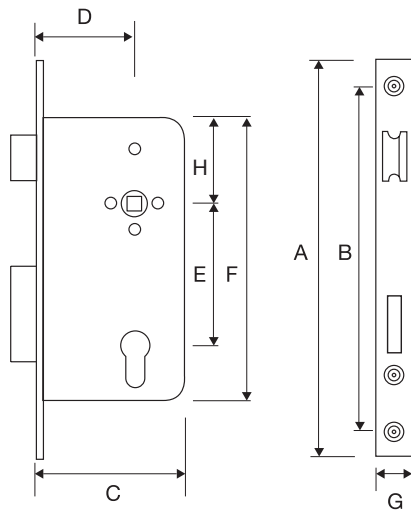

## Finishing

- M26D** - Satin Chrome
- M10B** - Matt Black

## Feature

- Sirim Approval
- Grade 3 security
- 200,000 cycles test
- All Weather

## Specification

- For Flush timber door
- Latch operated with lever handle
- Deadbolt operated with profile cylinder
- Solid brass latch / Deadbolt
- Reversible latch
- Backset 25mm to 70mm



CERTIFIED TO: ANSI/BHMA A 156.13:2005  
Certification No: PC000360



## BS EN Rating

3	S	9	0	0	G	4	H	C	1	0
---	---	---	---	---	---	---	---	---	---	---

### ENTRANCE

1



- With latch bolt and deadbolt
- Latch bolt is operated by both lever and cylinder
- Deadbolt is operated by cylinder

### STOREROOM

4



- With only latch bolt
- External lever is always rigid, latch bolt is operated by using key outside
- Internal lever is always fine

### ENTRANCE WITH ROLLER

1B



- Deadbolt operated with profile cylinder
- Flexible ball catch to hold door

### DEAD LATCH

6



- With only deadbolt
- Deadbolt is operated by using cylinder
- No lever handle

### PRIVACY

2



- With latch bolt and deadbolt, no key but with indicator
- Inside is locked by operating the indicator thumb turn
- Outside can use coin to unlock under emergency circumstances

### PANIC FUNCTION

1A



- For escape door function
- Door can be opened by activating the lever and locked with the key (from inside)
- To enter from outside, opened and locked with the key and lever

### PASSAGE

3



- With only latch bolt, no cylinder
- Latch bolt is operated by both internal and external lever

### CLASSROOM

7



- With latch bolt, external lever lock or unlocked by key or tumbturn profile
- Latch bolt is operated by both lever and cylinder
- Internal always free providing emergency exit

1 Entrance Latch | Weight • 1A Panic Function • 1B Entrance Roller | Weight • 2 Privacy | Weight • 3 Passage | Weight  
4 Store | Weight • 6 Dead Latch | Weight • 7 Class room | Weight

Stock	Size (MM)	A	B	C	D	E	F	G	H	Packing	1	1A	1B	2	3	4	6	7
GML85251	25 X 85	240	210	43	25	85	172	22	55	20	✓ 12		✓ 8.5				✓ 11.5	
GML8531	30 X 85	240	210	48	30	85	172	22	55	20	✓ 13.3							
GML8541	40 X 85	240	210	67	40	85	172	22	55	20	✓ 13							
GML85451	45 X 85	240	210	72	45	85	172	22	55	20	✓ 16							
GML8551	50 X 85	240	210	76	50	85	172	22	55	20	✓ 13.8		✓ 18					
GML8561	60 X 85	240	210	87 <sup>93</sup>	60	85	172	22	55 <sup>63</sup>	20	✓ 16	✓ 18.5	✓ 18	✓ 18	✓	✓	✓ 16	✓ 16
GML8571	70 X 85	240	210	97	70	85	172	22	55	20	✓ 16							
GML857261	60 X 72	240	210	93	60	72	172	22	63	20	✓ 18.5	✓ 18.5						
GML40SD	40	165	138	68	40	34	102	23	34	30							✓ 16	
GML40DL	40	165	138	68	40	34	102	23	34	30							✓ 16	
GML50DH	50	165	140	67	50	35	102	23	45	30							✓ 13.6	





# Mortise Lock Function

## Mortise Sash Lock Mortise Anti-Panic

GML8561 / GML857261 / GML85861



## Mortise Roller

GML 8561B



## Mortise Privacy

GML 8562



## Mortise Passage

GML 8563



## Mortise Deadlock

GML 8566 / 85256



## Mortise Class Room

GML 8564 / GML 8567



## Mortise Double Hook Lock

GML 40SD



## Mortise Deadlock

GML 40DL



## Mortise Single Hook Lock

GML 50DH



# Profile Cylinder



## Thumbturn & Key Profile Cylinder



Diagram

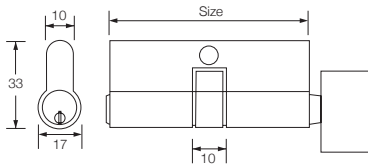

Stock Code	Size	Packing	Weight
GC601S	60mm	50 pcs	14.2 kgs
GC701S	70mm	50 pcs	15.7 kgs
GC801S	80mm	50 pcs	16 kgs
GC901S	90mm	50 pcs	17.3 kgs
GC125S	125mm	30 pcs	19 kgs

## Double Key Profile Cylinder



Diagram

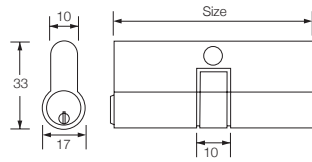

Stock Code	Size	Packing	Weight
GC500D	50mm	50 pcs	10.7 kgs
GC600D	60mm	50 pcs	12.1 kgs
GC700D	70mm	50 pcs	13.5 kgs
GC800D	80mm	50 pcs	14.9 kgs

## Thumbturn & Emergency Slot Profile Cylinder



Diagram

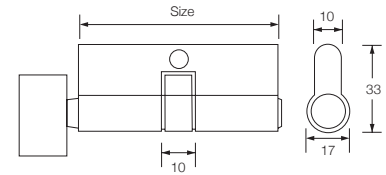

Stock Code	Size	Packing	Weight
GC602	60mm	50 pcs	11.5 kgs
GC702	70mm	50 pcs	12.9 kgs

## One Side Thumbturn Half Profile Cylinder



Diagram

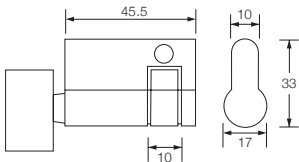

Stock Code	Size	Packing	Weight
GC455	45mm	50 pcs	9.8 kgs

## One Side Key Half Profile Cylinder



Diagram

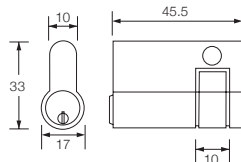

Stock Code	Size	Packing	Weight
GC459	45mm	50 pcs	9.8 kgs

## Oval Shape Profile Cylinder



Diagram  
GC540 (Double Key)

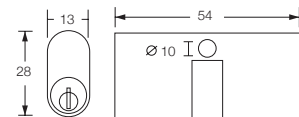

GC541 (Thumbturn)

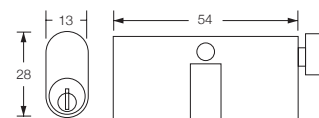

Stock Code	Size	Packing	Weight
GC540 D	54mm	50 pcs	9.5 kgs
GC541 S	54mm	50 pcs	11 kgs

### Finishing

- M26D - Satin Chrome ●
- M10B - Matt Black ●
- M28 - Dark Grey ●



CERTIFIED TO: ANSI/BHMA A 156.13:2005  
Certification No: PC000360

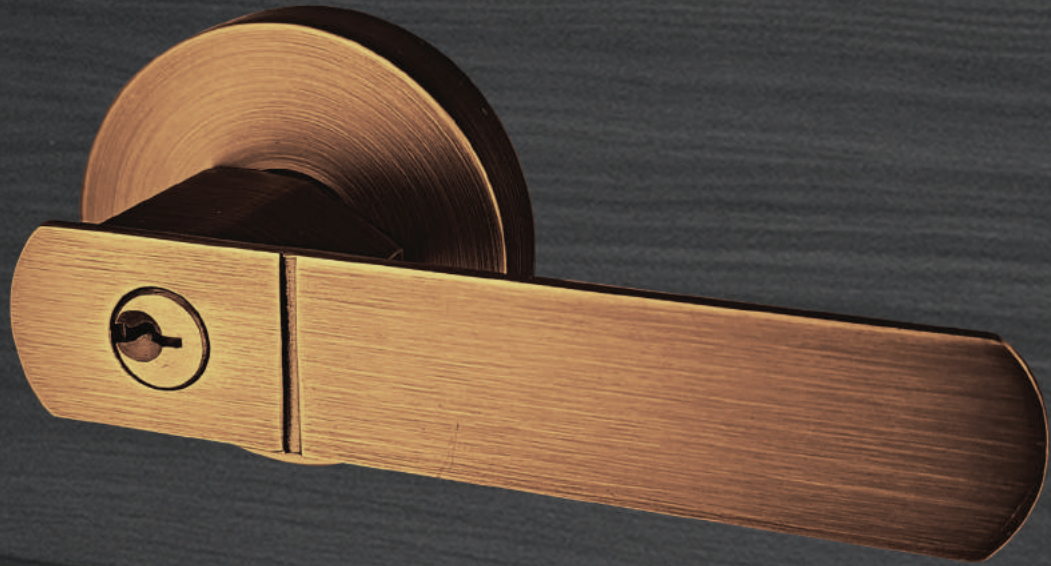

# TUBULAR LEVER



SIRM  
CERTIFIED TO: ANSI/BHMA A 156.2:2003  
Certification No: PC000359



# Tubular Lever



## Finishing

- M26D** - Satin Chrome
- M11** - Antique Copper
- M10B** - Matt Black
- M3M** - Satin Gold
- M28** - Dark Grey

## Specification

- Adjustable backset 60mm / 70mm
- Suitable door thickness 30mm to 45mm
- 3 Brass key
- Brass core cylinder
- SUS304 stainless steel knob & rose
- Heavy duty latch

## Feature

- Sirim Approval
- Grade 3 security
- 200,000 cycles test
- All Weather



SIRIM  
CERTIFIED TO: ANSI/BHMA A 156.2:2003  
Certification No: PC000359

## Diagram

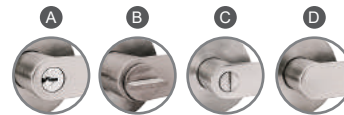
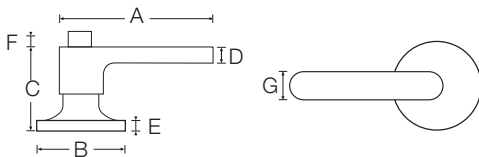

## Installation

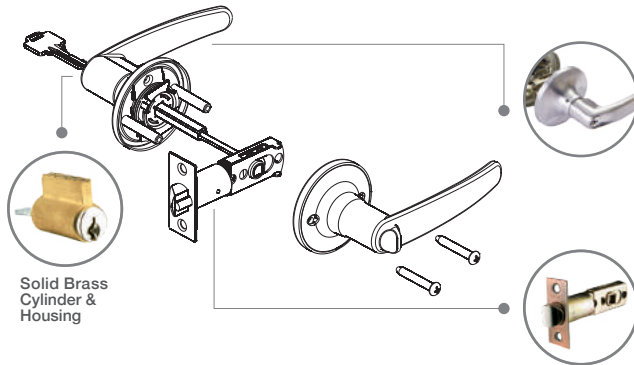

## Function

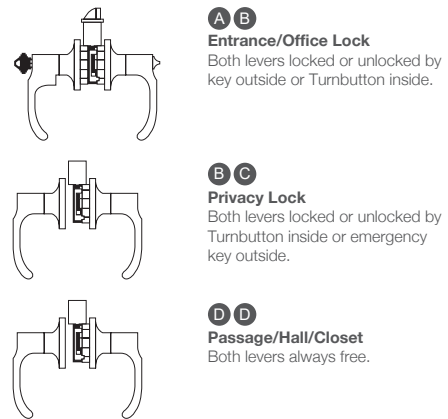

Stock Code	Size	A	B	C	D	E	F	G	Packing	Entrance / Weight	Privacy / Weight	Passage / Weight
G4001		120	70	56	8	16	13	25	24	✓ 20	✓ 18	✓ 17
G4101		120	70	60	18	16	10	9	24	✓ 24	✓ 20	✓ 20
G4201		125	70	56	13	16	13	17	24	✓ 20	✓ 18	✓ 17
G4301		133	70	56	9	16	10	27	24	✓ 24	✓ 18	✓ 17
G4501		130	70	55	19	16	10	19	24	✓ 24	✓ 18	✓ 17
G6111		120	75	60	8	7	10	22	24	✓ 25	✓ 25	
G6511		120	75	60	8	7	10	22	24	✓ 25	✓ 25	
G7011		120	75	62	10	7	10	25	24	✓ 25	✓ 25	
G7071		130	75	62	20	7	10	6	24	✓ 25	✓ 25	
G7091		120	75	60	9	7	10	24	24	✓ 25	✓ 18	
G7641		120	75	60	8	7	10	20	24	✓ 25	✓ 18	

# Tubular Lever

Model  
**G 4001**

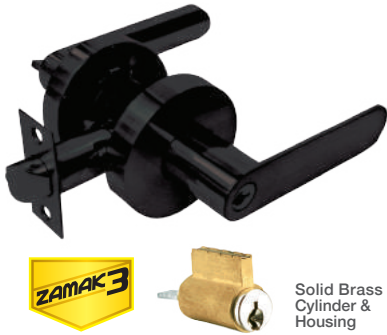

Model  
**G 4101**



Model  
**G 4201**



Model  
**G 4301**



Model  
**G 4501**

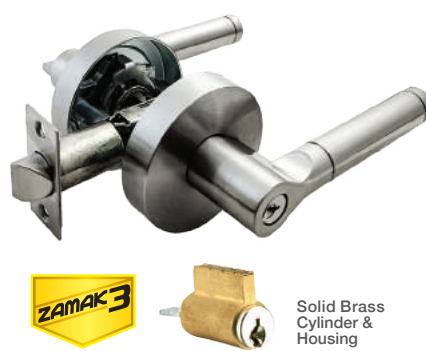

Model  
**G 6111**

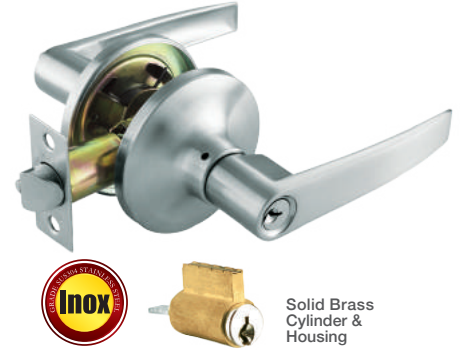

Model  
**G 6511**



Model  
**G 7011**



Model  
**G 7071**



Model  
**G 7091**



Model  
**G 7641**







**GERE**<sup>®</sup>  
Symbol of Quality



# CYLINDRICAL DOOR KNOB



CERTIFIED TO: ANSI/BHMA A 156.2:2003  
Certification No: PC000359



# Cylindrical Door Knob

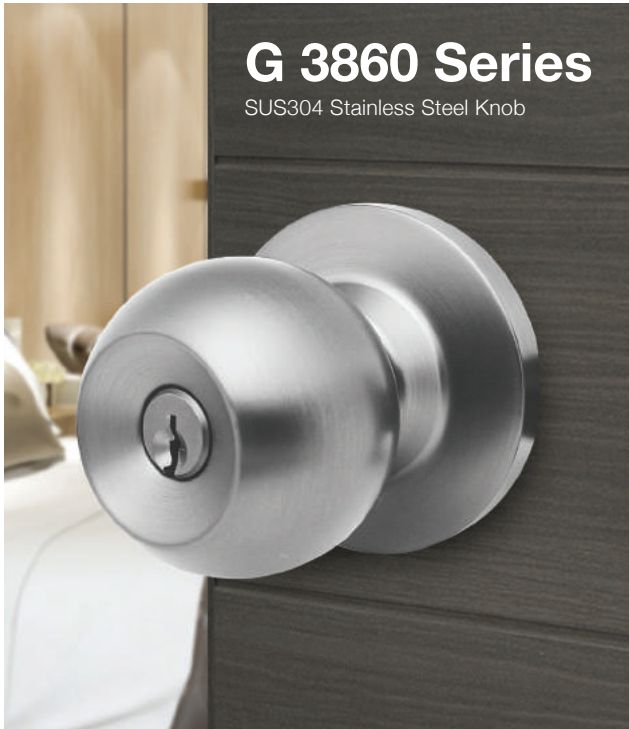

## Finishing

- |                             |   |                         |   |
|-----------------------------|---|-------------------------|---|
| <b>M26D</b> - Satin Chrome  |  | <b>M3M</b> - Satin Gold |  |
| <b>M11</b> - Antique Copper |  | <b>M28</b> - Dark Grey  |  |
| <b>M10B</b> - Matt Black    |  |                         |   |

## Specification

- Standard backset 60mm
  - Suitable door thickness 30mm - 45mm
  - 3 Brass key
  - Brass core cylinder
  - SUS304 stainless steel knob & rose
  - Heavy duty latch
  - Wooden knob\*
- \* Exclusively for G9881

## Feature

- Sirim Approval
- Grade 3 security
- 200,000 cycles test
- All Weather



CERTIFIED TO: ANSI/BHMA A 156.2:2003  
Certification No: PC000359

## Diagram

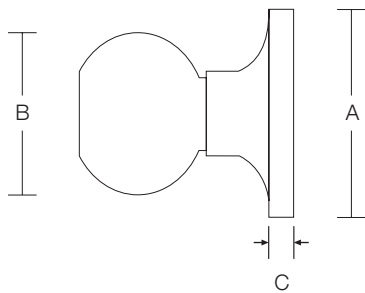



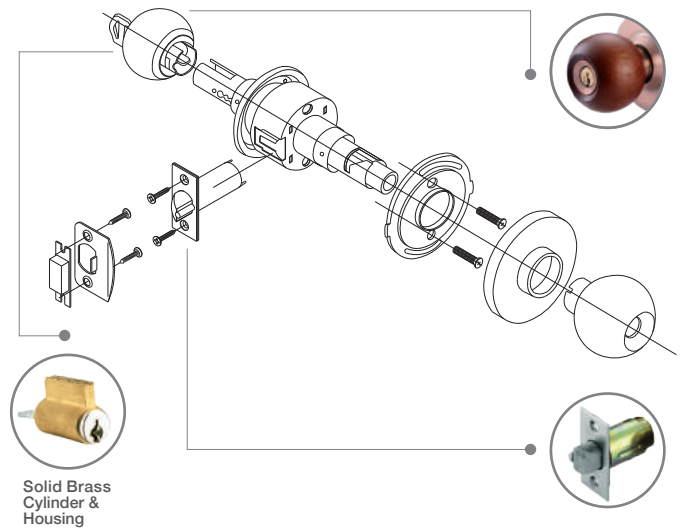



## Installation

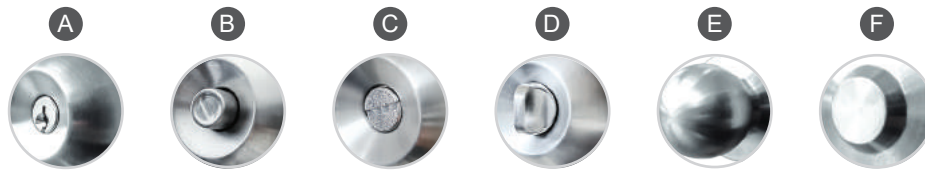

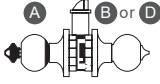
Stock Code	Size	A	B	C	Packing	Entrance / Weight	Privacy / Weight	Passage / Weight	Storeroom / Weight	Communication / Weight	Classroom / Weight	Patio / Weight	Communicating / Weight	Exit / Weight
G3861		65	54	7	30	✓ 20	✓ 19	✓ 19	✓ 20	✓ 17	✓ 20	✓ 19	✓ 21	✓ 18
G9501		70	54	8	24	✓ 19	✓ 18	✓ 18						
G9881		70	54	8	24	✓ 19	✓ 18	✓ 18						

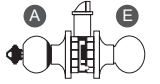
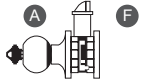
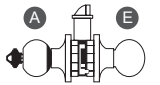
# Cylindrical Door Knob

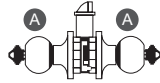

FUNCTION		
<b>ENTRANCE / OFFICE LOCK</b>		<b>G 3861</b> <ul style="list-style-type: none"> <li>Both knobs locked or unlocked by key outside or push or thumb turn button inside.</li> </ul>
<b>PRIVACY LOCK</b>		<b>G 3862</b> <ul style="list-style-type: none"> <li>Latch bolt operated by knob from either side knob is locked by push or thumb turn button inside and unlocked by emergency release outside, rotating inside knob or closing door. The inside knob is always unlocked providing emergency exit.</li> </ul>
<b>PASSAGE / HALL / CLOSET</b>		<b>G 3863</b> <ul style="list-style-type: none"> <li>Either knob operates latch bolt at all times.</li> </ul>
<b>STORE ROOM / HOTEL ROOM</b>		<b>G 3864</b> <ul style="list-style-type: none"> <li>Outside knob unlocked only while key is inserted and turned. Pull key locked. Inside knob always free providing emergency exit.</li> </ul>
<b>COMMUNICATION LOCK</b>		<b>G 3865</b> <ul style="list-style-type: none"> <li>Both knobs unlocked only while key is inserted and turned. Pull key locked.</li> </ul>
<b>CLASSROOM LOCK</b>		<b>G 3866</b> <ul style="list-style-type: none"> <li>Outside locked or unlocked by key outside. Inside always free providing emergency exit.</li> </ul>
<b>PATIO LOCK</b>		<b>G 3867</b> <ul style="list-style-type: none"> <li>Both knobs locked or unlocked by push button inside. Closing door does not release button.</li> </ul>
<b>COMMUNICATING LOCK</b>		<b>G 3868</b> <ul style="list-style-type: none"> <li>Both knobs locked or unlocked by key in either knob. Turning key locks or unlocks its own knob independently.</li> </ul>
<b>EXIT LOCK</b>		<b>G 3869</b> <ul style="list-style-type: none"> <li>Outside knob rigid. The inside knob is always unlocked providing emergency exit.</li> </ul>

Model

**G 3861**

SUS 304 Stainless Steel Knob



Model

**G 9501**

SUS 304 Stainless Steel Knob



Solid Brass  
Cylinder &  
Housing

Model

**G 9881**

Wooden Knob

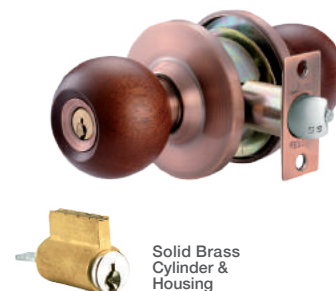

Solid Brass  
Cylinder &  
Housing

# Cylindrical Lever and Tubular Knob Set

## Tubular Knob Set

Model

### G 9771

SUS 304 Stainless Steel  
One Piece Knob



#### Diagram

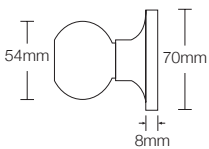

#### Finishing

**M26D** - Satin Chrome

**M11** - Antique Copper

**M10B** - Matt Black

**M3M** - Satin Gold

**M28** - Dark Grey

#### Specification

- Standard backset 60mm / 70mm
- Suitable door thickness 30mm - 45mm
- 3 Brass key
- Brass core cylinder
- SUS304 stainless steel knob & rose
- Heavy duty latch

#### Feature

- Sirim Approval
- Grade 3 security
- 200,000 cycles test
- All Weather

#### Function

- Entrance
- Privacy
- Passage

Stock Code	Packing	Weights
G 9771	24 pcs	19 kgs
G 9772	24 pcs	17 kgs
G 9773	24 pcs	16 lgs



CERTIFIED TO: ANSI/BHMA A 156.2:2003  
Certification No: PC000359

Model

### G 6261

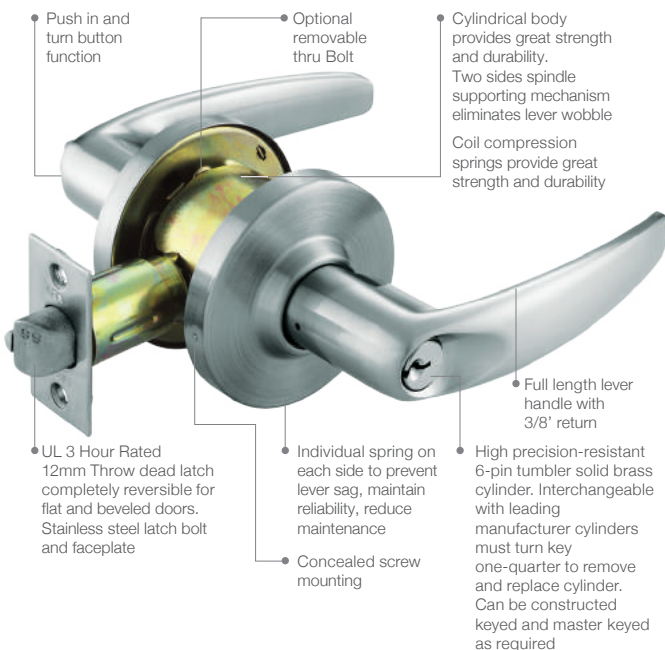

#### Finishing

**M26D** - Satin Chrome

#### Function

- Entrance

#### Specification

- Standard backset 70mm
- Suitable door thickness 38mm - 55mm
- 3 Brass key
- 6 pin tumbler brass core cylinder
- SUS304 Heavy duty latch
- Conceal screw mounting

#### Feature

- Sirim Approval
- Grade 3 security
- 200,000 cycles test
- All Weather

#### Diagram

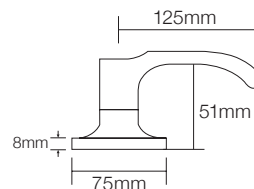

Stock Code	Packing	Weights
G 6261	12 pcs	25 kgs



CERTIFIED TO: ANSI/BHMA A 156.2:2003  
Certification No: PC000359



# Deadbolt

Model

## G 3100 Series

Deadbolt

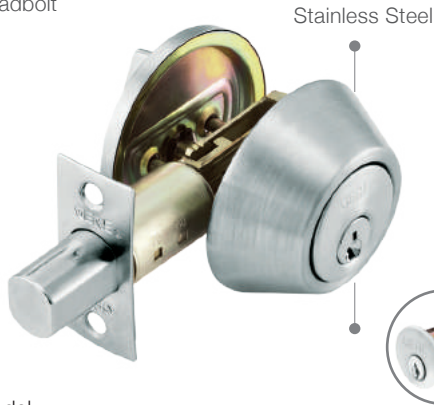

Stainless Steel

### Finishing

**M26D** - Satin Chrome

**M11** - Antique Copper

**M10B** - Matt Black

**M3M** - Satin Gold

**M28** - Dark Grey

### Specification

- Standard backset 60mm / 70mm
- Suitable door thickness 30mm - 45mm
- 3 Brass key
- Brass core cylinder
- Heavy duty latch
- Brass core cylinder 6 Pin\*
- 65mm solid metal one piece design\*
- 25mm deadbolt with harden steel core\*

### Feature

- Sirim Approval
- Grade 3 security
- 200,000 cycles test
- All Weather
- Grade 2 security\*
- 400,000 cycles test\*



CERTIFIED TO: ANSI/BHMA A 156.5:2001  
Certification No: PC000361

Model

## G 3200 Series

Heavy Duty Deadbolt

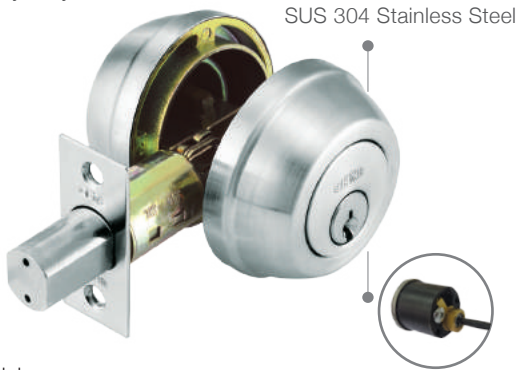

SUS 304 Stainless Steel

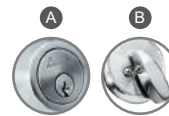

### Function

#### G 3101

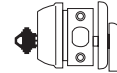

**A B**

#### Single Cylinder Thumbturn and Key

Deadbolt operated by key outside or Turnbutton inside.

#### G 3102

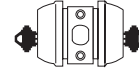

**A A**

#### Double Cylinder Key

Deadbolt operated by key outside or inside.

#### G 3105



**B**

#### Half Deadbolt

Deadbolt operated by Turnbutton only no outside trim.  
Bore halfway through door for installation visible from one side of the door only.

Model

## G 3500 Series

Deadbolt

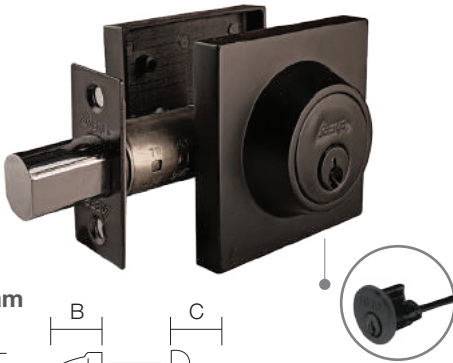

### Diagram

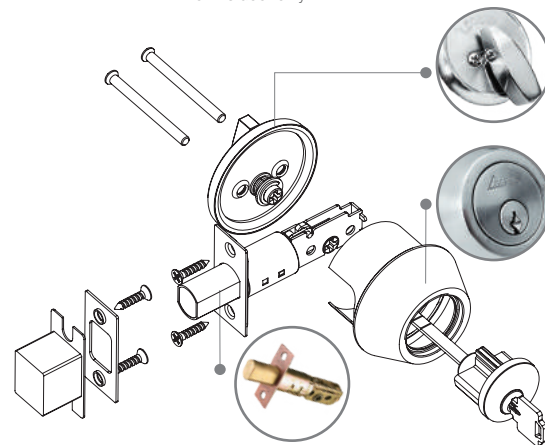
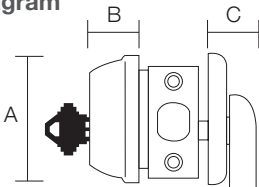

Stock Code	Size	A	B	C	Packing	Weight	M26D	M10B	M3M	M11	M28
G3101	65	25	25	24	13	✓	✓	✓	✓	✓	✓
G3102	65	25	25	24	15	✓	✓	✓	✓	✓	✓
G3105	65	25	25	24	9	✓				✓	✓
G3201*	65	25	25	24	18	✓	✓			✓	✓
G3202*	65	25	25	24	22	✓				✓	✓
G3501	65	25	25	24	13	✓	✓	✓	✓	✓	✓

\*exclusively for G3201 only



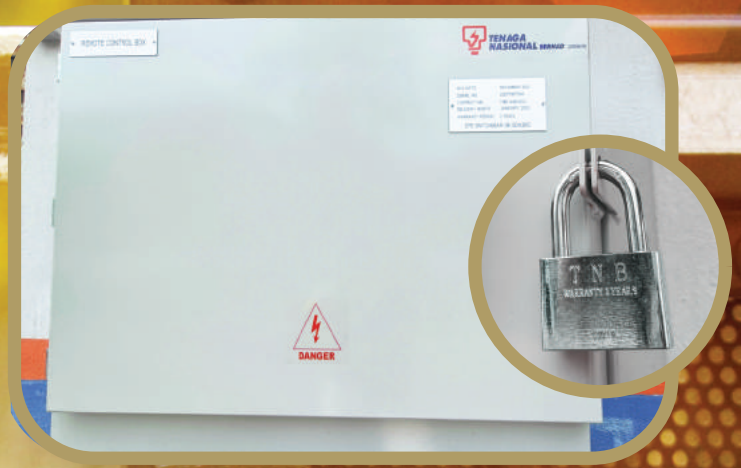

# HEAVY DUTY BRASS PADLOCK



SIRIM

CERTIFIED TO: BS EN 12320:2012  
Certification No: PC000683



# Padlock

Model  
**CL 54**  
Brass Padlock



Diagram

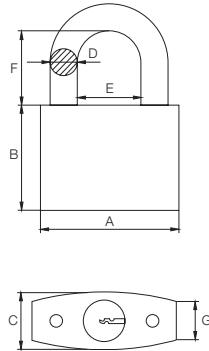

Size	A	B	C	D	E	F	G
15mm	15	18	9.5	3	8	10.5	6.5
20mm	20	20	10	3	10.5	12.5	6.5
25mm	25	24	11	4	13.5	15.5	6.5
30mm	30	28	13	5	15.5	17.5	8
30mm L	30	28	13	5	15.5	49	8
40mm	40	33	14	6.5	22	24	8.5
40mm L	40	33	14	6.5	22	64	8.5
50mm	50	40	16	8	28	30	9.5
50mm L	50	40	16	8	28	80	9.5
60mm	60	42	18	9.5	33.5	35.5	10.7

**Specification**

- Hardened steel shackle
- SUS stainless steel spring
- Solid brass body
- 3 Brass keys
- Solid brass cylinder
- 'Snap Shut' function
- Rekeyable
- Keyed alike set of 2 pcs/set up to 6 pcs is standard
- Keyed-Alike master keyed is available upon request
- Carded blister pack

(L-Long Shackle)

Stock Code	Size	Packing	Weight
CL 54 15	15 mm	144 pcs	8 kgs
CL 54 20	20 mm	120 pcs	10 kgs
CL 54 25	25 mm	120 pcs	12 kgs
CL 54 30	30 mm	120 pcs	17 kgs
CL 54 30L	30 mm	96 pcs	12.5 kgs
CL 54 40	40 mm	96 pcs	17 kgs
CL 54 40L	40 mm	72 pcs	15.5 kgs
CL 54 50	50 mm	72 pcs	21 kgs
CL 54 50L	50 mm	48 pcs	16 kgs
CL 54 60	60 mm	48 pcs	20 kgs

(L-Long Shackle)

Model  
**CL 59**  
Aluminium Padlock



Diagram

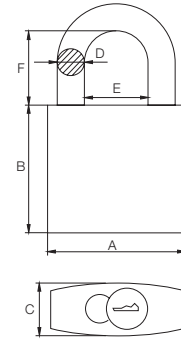

Princely Purple  
Colour Code: P

Size	A	B	C	D	E	F
50mm	50	50	20	10	23	30

**Specification**

- Rekeyable cylinder
- Stainless steel ball locking
- Both side Shackle locking system
- New padlock can be duplicated from a sample key
- Additional cylinder and padlock can be supplied keyed to this lock
- Precision pin tumble cylinder
- Can be keyed alike key to many security keyways
- Ultra light, colour anodized aluminium padlock body
- 'Snap Shut' function

**7 Colours**

Anodized aluminium padlock body available



Stock Code	Size	Packing	Weight
CL59AL50	50 mm	48 pcs	16 kgs



SIRM  
CERTIFIED TO: BS EN 12320:2012  
Certification No: PC000683



Model

## CL 93 SS

Brass Padlock with Stainless steel shackle



Diagram

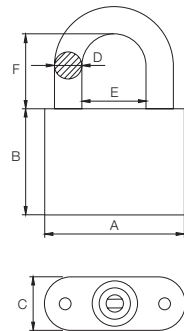

Threaded Bolt End Cap

Size	A	B	C	D	E	F
40mm	40	32	20	8	20	22
50mm	50	38	20	10	23	29
40mm L	40	32	20	8	20	48
50mm L	50	38	20	10	23	60

(L-Long Shackle)

### Specification

- Stainless steel shackle
- Solid satin chromed brass body
- 4 Brass keys
- Anti-Rust function
- Solid brass cylinder
- Stainless steel ball bearing
- Stainless steel disc
- Anti-Allenkey bend
- Key-Retaining function and rekeyable
- Keyed-Alike set available from 2 pcs/sets up to 6 pcs/sets
- Make to order up to 1000 pcs/sets is also available
- Masterkey set is available upon request
- Double blister pack for single padlock
- Skin packed for Keyed-Alike set & Master set
- Threaded bolt end cap

Stock Code	Size	Packing	Weight
CL 9340 SS	40 mm	48 pcs	15 kgs
CL 9350 SS	50 mm	48 pcs	22 kgs
CL 9340 SSL	40 mm	48 pcs	17 kgs
CL 9350 SSL	50 mm	48 pcs	24 kgs

(L-Long Shackle)



SIRIM  
CERTIFIED TO: BS EN 12320:2012  
Certification No: PC000683

Exceeds 10,000 cycles

Model

## CL 95

Brass Padlock



Diagram

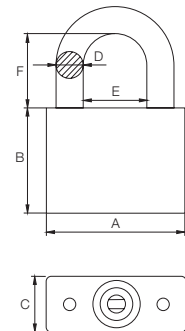

Size	A	B	C	D	E	F
40mm	40	32	20	8	20	22
50mm	50	38	20	10	23	27
40mm L	40	32	20	8	20	48
50mm L	50	38	20	10	23	60
55mm	55	42	20	11	25	28
60mm	60	42	20	11	27	28
75mm	75	50	20	11	40	40

(L-Long Shackle)

### Specification

- Hardened steel shackle
- Solid chromed body
- 4 Steel keys
- Brass disc
- Anti-Allenkey bend
- Key-Retaining function and rekeyable
- Keyed-Alike set of 2 pcs/sets up to 6 pcs/sets is standard
- Masterkey set of 2 pcs/sets up to 5 pcs/sets is standard
- Make to order up to 1000 pcs/sets is also available
- Keyed Alike and Master key is available for upon request
- Double blister pack for single padlock
- Skin packed for Keyed-Alike set & Master set

Stock Code	Size	Packing	Weight
CL 9540	40 mm	48 pcs	15 kgs
CL 9550	50 mm	48 pcs	20 kgs
CL 9540 L	40 mm	48 pcs	16 kgs
CL 9550 L	50 mm	48 pcs	22 kgs
CL 9555	55 mm	48 pcs	22 kgs
CL 9560	60 mm	48 pcs	24 kgs
CL 9575	75 mm	36 pcs	26 kgs

(L-Long Shackle)



## Model CL 91

Heavy duty Brass Armoured Padlock

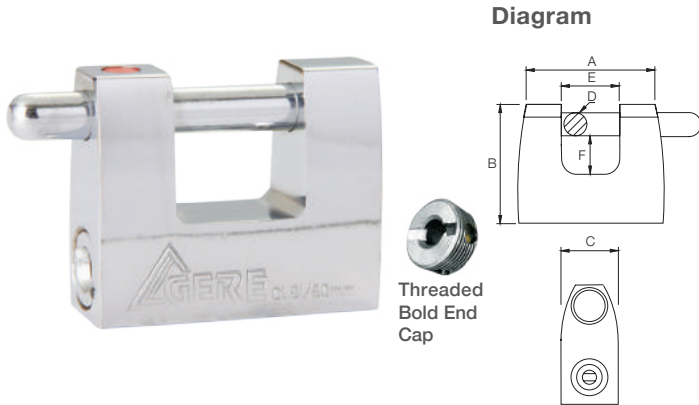

Size	A	B	C	D	E	F
50mm	52	47	22	8	22	15
60mm	62	52	22	9	26	18
70mm	70	57	24	10	32	21.5

### Specification

- Solid chromed brass body
- 4 Brass keys
- Brass cylinder
- Stainless steel disc
- Anti-Allenkey bend
- Threaded bolt end cap
- Stainless steel ball bearing
- Key-Retaining function and rekeyable
- Keyed-Alike set of 2 pcs/sets up to 6 pcs / sets is standard
- Make to order up to 1000 pcs/sets is available
- Masterkey set is available upon request
- Double blister pack for single padlock
- Skin packed for Keyed-Alike set & Master set

Stock Code	Size	Packing	Weight
CL 9150	50 mm	48 pcs	17 kgs
CL 9160	60 mm	48 pcs	21 kgs
CL 9170	70 mm	48 pcs	25 kgs

## Model CL 99

Anti Cut Shackle Heavy Duty Brass Padlock

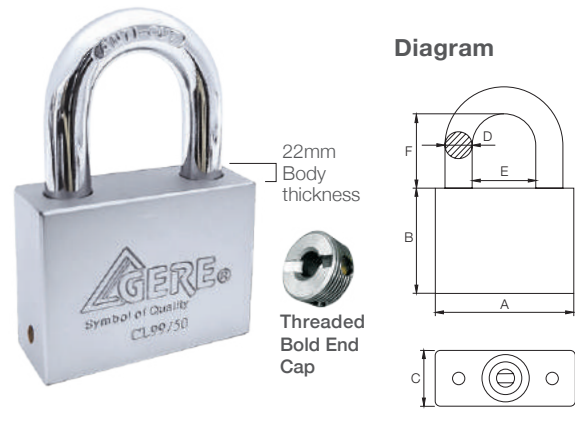

Size	A	B	C	D	E	F
40mm	42	36	22	8	20	23
50mm	52	39	22	10	23	28
60mm	62	42	22	10.8	27	26
70mm	72	50	22	12	36	37

### Specification

- Alloy steel shackle
- Anti-Cut
- Solid satin chromed brass body
- 4 Brass keys
- Brass cylinder
- Stainless steel disc
- Anti-Allenkey bend
- 22mm Body thickness
- Threaded bolt end cap
- Stainless steel ball bearing
- Key-Retaining function and rekeyable
- Keyed-Alike set of 2 pcs/sets up to 6 pcs / sets is standard
- Make to order of up to 1000 pcs/sets is available
- Masterkey set is available upon request
- Double blister pack for single padlock
- Skin packed for Keyed-Alike set & Master set

Stock Code	Size	Packing	Weight
CL 9940	40 mm	48 pcs	17 kgs
CL 9950	50 mm	48 pcs	23 kgs
CL 9960	60 mm	48 pcs	28 kgs
CL 9970	70 mm	48 pcs	37.5 kgs



Certified to  
EN 1670: 2007/AC:2009



BSEN ISO 9227:2007  
BSEN 1670:2007



CERTIFIED TO: BS EN 12320:2012  
Certification No: PC000683



Certified to  
CEN EN 12320 : 2012 GRADE 3  
EUROPEAN STANDARD



Certified to  
BS EN 12320: 2012 GRADE 3  
UK STANDARD

Exceeds  
10,000 cycles

Model  
**CL 90**

Anti Cut Shackle Heavy Duty Brass Padlock



Threaded Bolt End Cap

Diagram

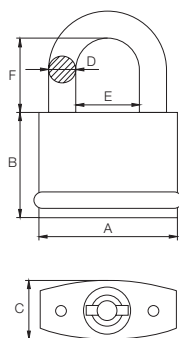

Size	A	B	C	D	E	F
50mm	50	39	22	10	23	29

Specification

- Alloy Steel Shackle
- Anti-cut
- Chrome brass body
- 4 Brass keys
- Brass Cylinder
- Stainless steel disc
- Threaded bolt end cap
- Stainless steel bearing
- Key-Retaining function and rekeyable
- Keyed alike / Master key available
- Double blister pack

Stock Code	Size	Packing	Weight
CL 9050	50 mm	48 pcs	22 kgs

Model  
**Numeric Brass Padlock**



Diagram

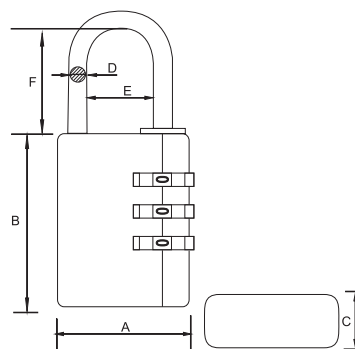

Size	A	B	C	D	E	F
20mm (3D)	21	29	10	3	9	22
20mm (4D)	21	35	10	3	9	22
30mm (3D)	28	42	12.5	5	13	26
40mm (4D)	38	49	13	6.2	19	30
50mm (4D)	50	52	15	8	27	42

Stock Code	Size	Packing	Weight
CL 32203D	20 mm	240 pcs	18 kgs
CL 32204D	20 mm	240 pcs	19 kgs
CL 32303D	30 mm	120 pcs	20 kgs
CL 32404D	40 mm	80 pcs	22 kgs
CL 32504D	50 mm	40 pcs	20 kgs



CERTIFIED TO: BS EN 12320:2012  
Certification No: PC000683

Exceeds  
10,000 cycles



# TSA Series Luggage Lock Vehicle Lock | Car Steering Lock



Model  
**CL 32-338 TSA**

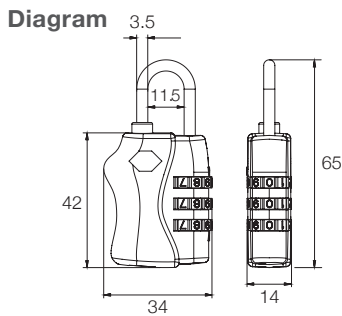

**Specification**

- ABS material
- Help The TSA ensure safe and secure air travel
- Up to date with the latest regulations in locking checked baggage
- Each Travel Sentry TM certified lock includes a special ID mark alerting the TSA they can open this lock without breaking it
- Each lock contains a special TSA code
- The TSA are able to use the codes and special tools to open and relock your luggage after inspection



Stock Code	Size	Packing	Weight
CL 32-338 TSA	34 mm	100 pcs	6 kgs

Model  
**CL 32-335 TSA**

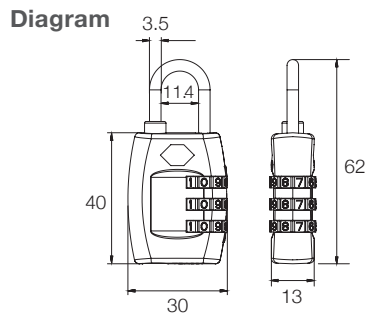

Stock Code	Size	Packing	Weight
CL 32-335 TSA	30 mm	100 pcs	6 kgs

Model  
**CL 32-21100 TSA**

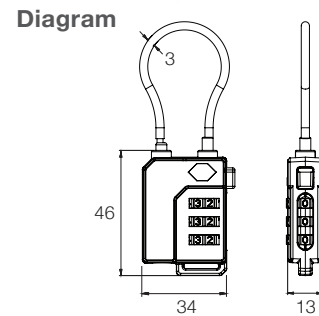

Stock Code	Size	Packing	Weight
CL 32-21100 TSA	34 mm	100 pcs	6 kgs

Model  
**GPL 207 /50**

Smart Padlock

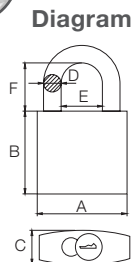

Size	A	B	C	D	E	F
50mm	50	60	21	10	23	32

**Specification**

- 20 Users
- USB Charger
- Fully Charge on 20 Minutes
- Up To 9 Monthes usage
- Stainless Steel SUS304
- IP65 Rated Weather Resistance
- Shock Proof
- Dust Proof



Model  
**GW 740SS**

Disc Brake Lock

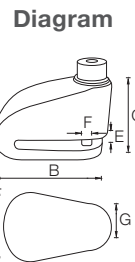

Size	A	B	C	D	E	F
50mm	56	84	57	8	7.5	6

**Specification**

- Stainless Steel SUS 304
- Weather Resistance
- 130db High Pitch Alarm
- Movement and Shock Sensor
- CR2 battery



Model

## CL 32-20815

Vehicle Lock



Diagram

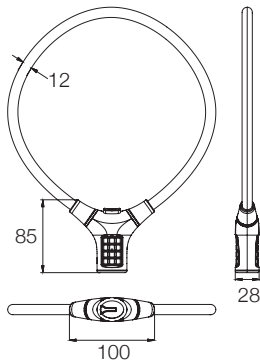

Stock Code	Size	Packing	Weight
CL 32-20815	100 mm	20 pcs	9 kgs

Model

## CL 32-20800

Vehicle Lock



Diagram

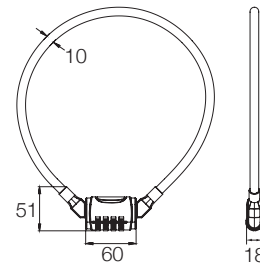

Stock Code	Size	Packing	Weight
CL 32-20800	60 mm	20 pcs	8.5 kgs

Model

## CL 32-12602

Steering Wheel Combination Lock



Diagram

CL 32-12368

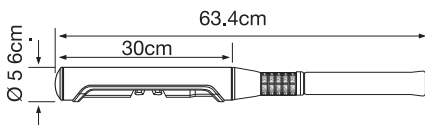

CL 32-12602

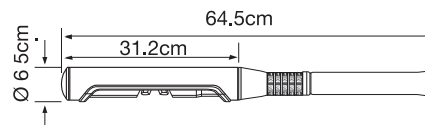

Stock Code	Size	Packing	Weight
CL 32-12368	63.4 cm	10 pcs	22 kgs
CL 32-12602	64.5 cm	10 pcs	24 kgs



# DOOR CLOSER



CERTIFIED TO: BS EN 1154 : 1997  
Certification No: PC001791



BS EN 1154:1997



FIRE RATED





Model

## G 800 Series



**Diagram**  
G 80 / G 801 / G 801BC / G 802H

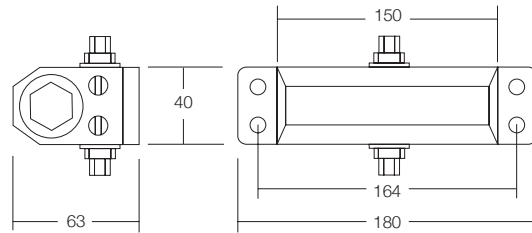

**Diagram**  
G 805 BC

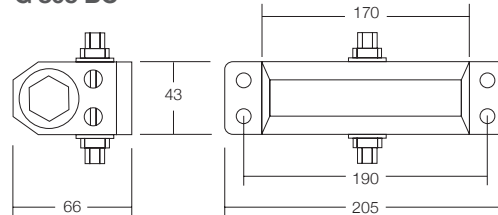

**Diagram**  
G 806 BC

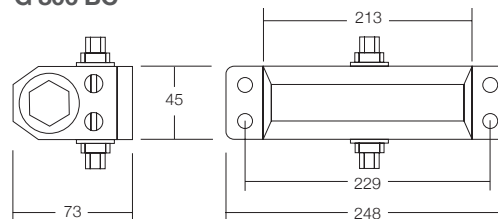

Stock Code	Size	Packing	Weight
G80 G801BC G801 G802H	180 mm	10 pcs	17 kgs
G 805 BC	205 mm	10 pcs	21 kgs
G 806 BC	248 mm	10 pcs	25 kgs

Back Check (G 805BC & G 806BC) The swing of a forcefully opened door is reduced. EN4 to EN6

Technical Info	G80/G801BC/G801/G802H EN3	G805BC EN5	G806BC EN6
Width of Door Max (mm)	950	1250	1400
<b>Weight of Door Max (kg)</b>	<b>60</b>	<b>100</b>	<b>120</b>
Max Opening Angle	180 °		
Back check Function	Yes (G801BC only)	Yes	
Hold - Open	G802H Built in hold open	No	
Applicable Temperature	-30 °C - 40 °C		
Applicability	Left Open or Right Open Door		
Weight of Body (kg)	0.85	1.25	1.55
Dimension of Main Body (mm)	Length	180	205
	Width	40	43
	Height	63	66
Passed Durability Test	500,000 Cycles (G80 N/A)	500,000 Cycles	
Sirim	Yes (G80 N/A)	Yes	

BS EN Rating	Digit 1	Digit 2	Digit 3	Digit 4	Digit 5	Digit 6
G801BC/G801/G802H	4	8	3	-	1	3
805 BC	4	8	5	-	1	3
806 BC	4	8	6	-	1	3

- Digit 1 - category of use  
Grade 4 describes closing door from 180 degree open
- Digit 2 - Durability  
Grade 8 describes 500,000 cycles test
- Digit 3 - Door Mass  
Identify the closing power of the closer by max door width and weight
- Digit 4 - Sustainability for use in fire door (grade 0 - 1)
- Digit 5 - Safety ( grade 0 - 1)  
Grade 1 identify the closer is hazard-free
- Digit 6 - Corrosion Resistance ( Grade 0 to 4)  
Grade 4 describes very high Resistance



CERTIFIED TO: BS EN 1154 : 1997  
Certification No: PC001791



**BS EN 1154 : 1997**  
Passed durability test  
500,000 cycles.



# Door Closer | Door Selector



Model

## G 803

Slim Body Door Closer



Diagram

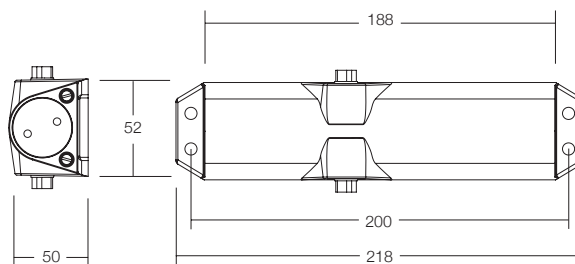

Stock Code	Size	Packing	Weight
G 803	218 mm	10 pcs	14.4 kgs

Technical Info		G803 BCEN4
Width of Door Max (mm)		1100
Weight of Door Max (kg)		80
Max Opening Angle		180 °
Back check Function		No
Hold - Open		No
Applicable Temperature		-30 °C - 40 °C
Applicability		Left Open or Right Open Door
Weight of Body (kg)		0.80
Dimension of Main Body (mm)	Length	218
	Width	52
	Height	50
Passed Durability Test		500,000 Cycles

BS EN Rating

803	4	8	4	-	1	3
-----	---	---	---	---	---	---



CERTIFIED TO: BS EN 1154 : 1997  
Certification No: PC001791



BS EN 1154 : 1997  
Passed durability test  
500,000 cycles.

Model

## GDL 280

Door Selector



Diagram

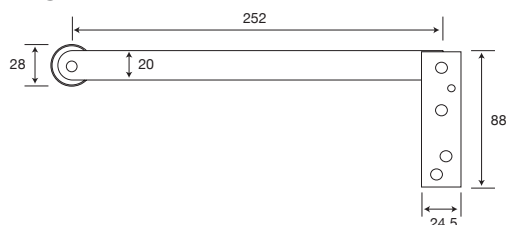

Stock Code	Size	Packing	Weight
GDL 280	252 mm	40 pcs	14.2 kgs



CERTIFIED TO: BS EN 1158 : 1997  
Certification No: PC001789



BS EN 1158 : 1997  
Passed durability test  
50,000 cycles.



Model

## GDC 006

Door Selector



Diagram

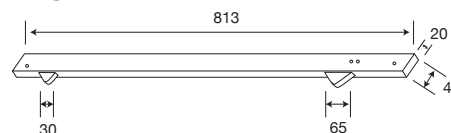

Stock Code	Size	Packing	Weight
GDC 006 (32")	813 mm	20 pcs	32.2 kgs
GDC 006 (42")	1070 mm	20 pcs	23.0 kgs
GDC 006 (52")	1320 mm	12 pcs	27.0 kgs



CERTIFIED TO: BS EN 1158 : 1997  
Certification No: PC001789



Model

## G 832

Concealed Door Closer



Finishing



Diagram

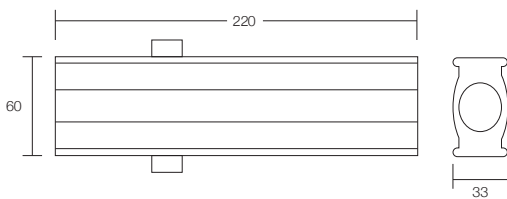

Stock Code	Size	Packing	Weight
G 832	220 mm	10 pcs	18 kgs

Model

## G 96V

Cam Action Concealed Door Closer



Diagram

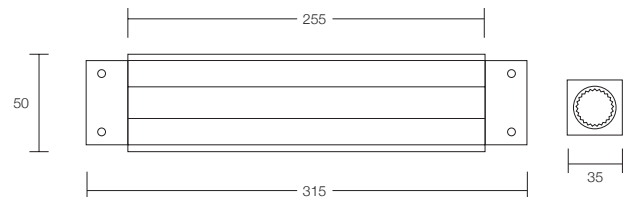

Stock Code	Size	Packing	Weight
G 96V	315 mm	10 pcs	27 kgs



CERTIFIED TO: BS EN 1154 : 1997  
Certification No: PC001791



BS EN 1154 : 1997  
Passed durability test  
500,000 cycles.



FIRE RATED

Back Check (G 805BC & G 806BC) The swing of a forcefully opened door is reduced. EN4 to EN6

Technical Info	G832 EN3	G96V EN4
Width of Door Max (mm)	950	1000
<b>Weight of Door Max (kg)</b>	<b>60</b>	<b>80</b>
Max Opening Angle	180 °	180 °
Back check Function	No	No
Hold - Open	Yes	Yes
Applicable Temperature	-30 °c - 40 °c	
Applicability	Left Open or Right Open Door	
Weight of Body (kg)	1.30	1.80
Dimension of Main Body (mm)	Length	220
	Width	33
	Height	60
Passed Durability Test	500,000 Cycles	



# Door Closer | Bracket and Arm



Model

## G 8

Parallel Arm Bracket

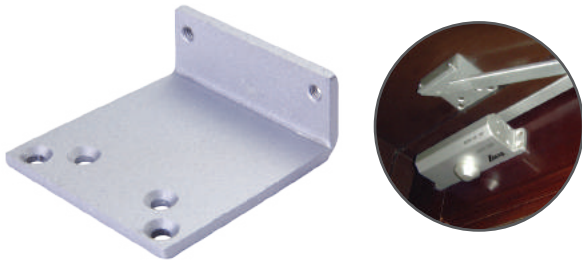

Diagram

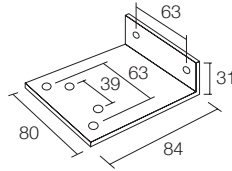

Stock Code	Size	Packing	Weight
G 8	84 mm	40 pcs	14 kgs

Model

## G 88 - ARM

Slide Arm

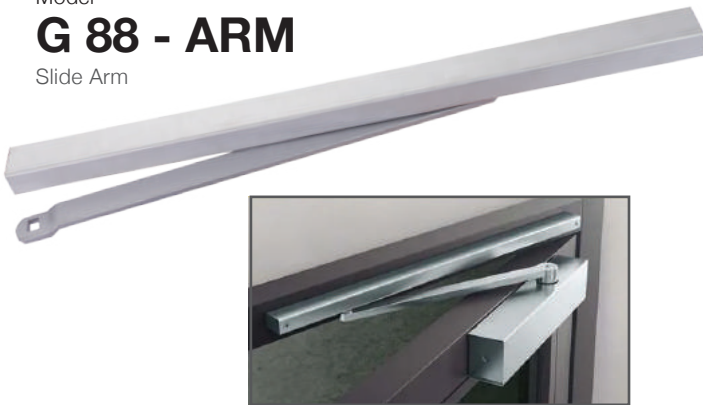

Diagram

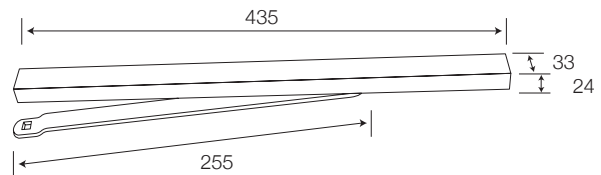

Stock Code	Size	Packing	Weight
G 88	435 mm	50 pcs	29.5 kgs

Model

## G - D ARM

Hold Open Arm



Diagram

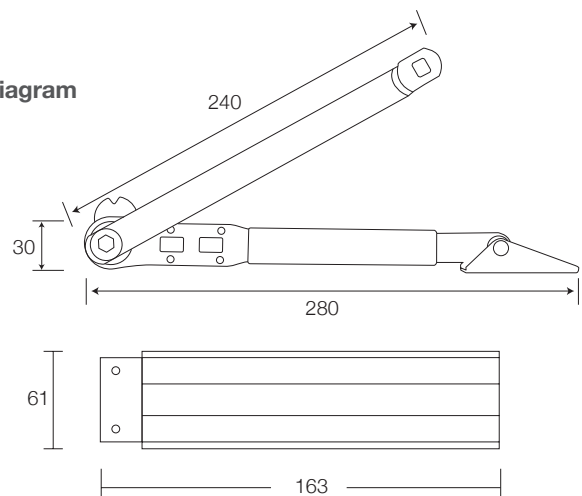

Stock Code	Size	Packing	Weight
G - D ARM	280 mm	40 pcs	23 kgs

# FLOOR SPRING SERIES



GP 050



GP 040



GP-PT24



GP 020



GP 030



GP 010



SIRIM

CERTIFIED TO: BS EN 1154 : 1997  
Certification No: PC001790



BS EN 1154 : 1997  
Passed durability test  
500,000 cycles.



# Floor Hinge 300 | 700 | 800 Series



Model

## GFS 304

Floor Hinge



Diagram  
GFS 304

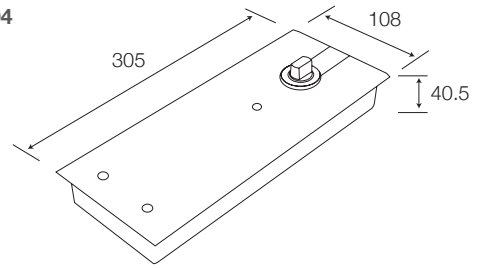

Diagram  
GFS 754

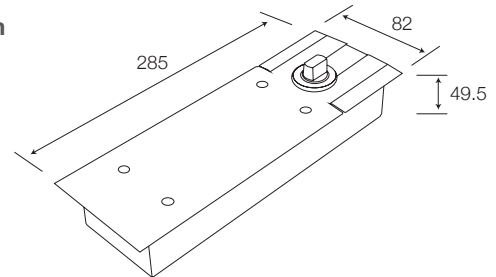
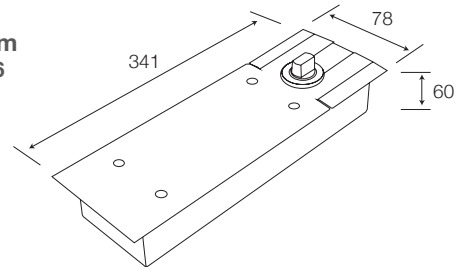

Diagram  
GFS 806



### Finishing

M26D - Satin Chrome

M10B - Matt Black



Stock Code	Size	Packing	Weight
GFS 304	305 mm	4 pcs	25.7 kgs
GFS 754	285 mm	4 pcs	24.5 kgs
GFS 806	341 mm	2 pcs	18 kgs

Technical Info		GFS304 EN4	GFS754 EN4	GFS806 EN6
Width of Door Max (mm)		1100	1100	1400
<b>Weight of Door Max (kg)</b>		<b>120</b>	<b>150</b>	<b>300</b>
Max Opening Angle		130 °	180 °	
Closing Speed Adjustment	Speed 1	90 ° - 25 °	90 ° - 15 °	180 ° - 15 °
	Speed 2	25 ° - 0 °	15 ° - 0 °	
Weight of Body (kg)		5.2	4.55	8.0
Dimension of Cement Box (mm)	Length	305	285	341
	Width	108	82	78
	Height	40.5	49.5	60
Passed Durability Test		500,000 cycles		
Applicability		Wooden, Glass & Aluminium Door etc.		



CERTIFIED TO: BS EN 1154 : 1997  
Certification No: PC001790



BS EN 1154 : 1997  
Passed durability test  
500,000 cycles.





Model  
**GP 010**

Bottom Patch Fitting



**Diagram**

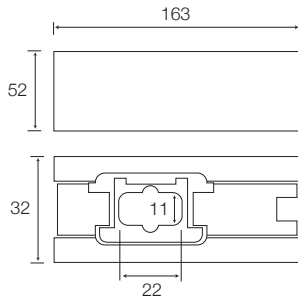

**Finishing**

**M26D** - Satin Chrome ●  
**M10B** - Matt Black ●

Stock Code	Size	Packing	Weight
GP 010	163 mm	20 pcs	13 kgs

Model  
**GP 020**

Top Patch Fitting



**Diagram**

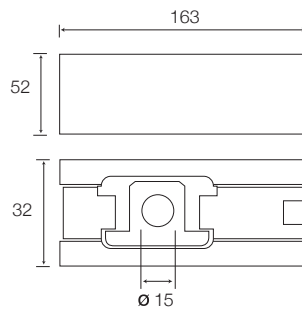

**Finishing**

**M26D** - Satin Chrome ●  
**M10B** - Matt Black ●

Stock Code	Size	Packing	Weight
GP 020	163 mm	20 pcs	12.4 kgs

Model  
**GP 030**

Patch Lock C/W Double Cylinder



**Diagram**

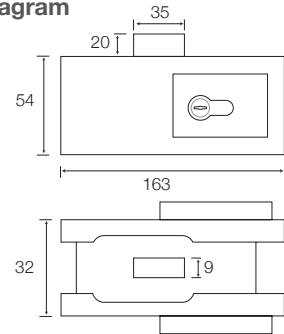

**Finishing**

**M26D** - Satin Chrome ●  
**M10B** - Matt Black ●

Stock Code	Size	Packing	Weight
GP 030	163 mm	20 pcs	15.3 kgs

Model  
**GP 040**

Size Patch Fitting



**Diagram**

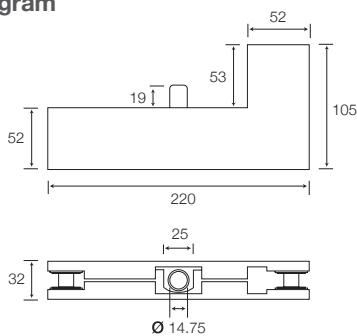

**Finishing**

**M26D** - Satin Chrome ●  
**M10B** - Matt Black ●

Stock Code	Size	Packing	Weight
GP 040	220 mm	20 pcs	20.1 kgs

Model  
**GP 050**

Over Patch Fitting



**Diagram**

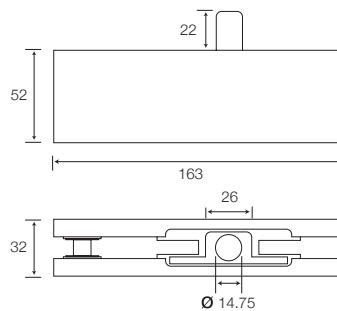

**Finishing**

**M26D** - Satin Chrome ●  
**M10B** - Matt Black ●

Stock Code	Size	Packing	Weight
GP 050	163 mm	20 pcs	13.4 kgs

# Patch Fitting



Model  
**GP - PT15**  
Floor Pivot



Diagram

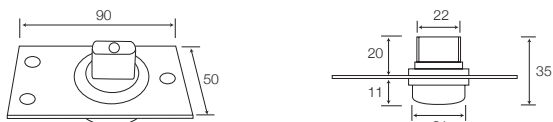

Stock Code	Size	Packing	Weight
GP - PT15	90 mm	120 pcs	28.8 kgs

Model  
**GP - PT24**  
Top Pivot



Diagram

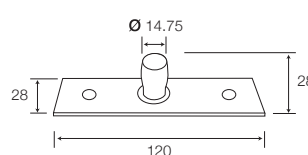

Stock Code	Size	Packing	Weight
GP - PT24	120 mm	200 pcs	20.6 kgs

Model  
**GPW - T24**  
Top Pivot

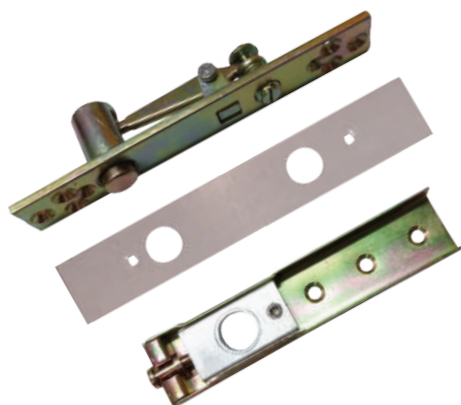

Diagram

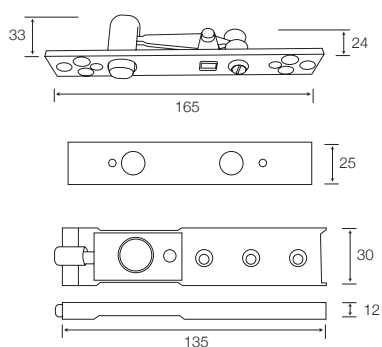

Stock Code	Size	Packing	Weight
GPW - T24	165 mm	50 pcs	19.5 kgs

Model  
**GPW - T15**  
Floor Pivot



Diagram

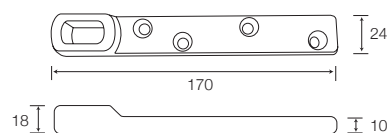

Stock Code	Size	Packing	Weight
GPW - T15	170 mm	50 pcs	15.2 kgs

# BLACK SERIES



CERTIFIED TO: BS EN 1154 : 1997  
Certification No: PC001790



BS EN 1154:1997  
Passed durability test  
500,000 cycles.





# Pull Handle

Model

## GPH 041

Pull Handle



Diagram

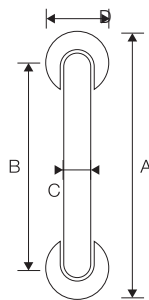

**Material**

SUS 304 Stainless Steel

**Finishing**

- M26D** - Satin Chrome ●
- M10B** - Matt Black ●
- M3M** - Satin Gold ●



Stock Code	Size	A	B	C	D	Packing	Weight (KG)
GPH 041	150mm	170	150	19	65	50	14
GPH 041	250mm	270	250	19	65	50	16

Model

## GPH 1 GPH 2

Push Handle

Pull Handle

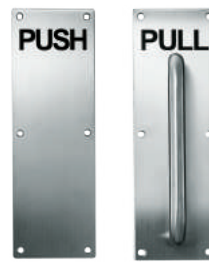

100mm x 300mm x 1.5mm

Diagram

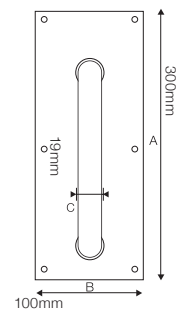

**Material**

SUS 304 Stainless Steel

**Finishing**

- M26D** - Satin Chrome ●
- M10B** - Matt Black ●
- M3M** - Satin Gold ●



Stock Code	Size	A	B	C	Packing	Weight (KG)
GPH 1	100x300mm	300	250	32	50 pcs/ctn	19.5
GPH 2	100x300mm	300	250	32	50 pcs/ctn	19.5

Model

## GSL 224

Pull Handle



Diagram

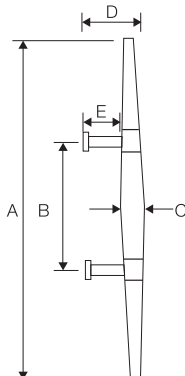

**Material**

SUS 304 Stainless Steel

**Finishing**

- M26D** - Satin Chrome ●
- M10B** - Matt Black ●
- M3M** - Satin Gold ●

Size	A	B	C	D	E
450mm	450	250	32	75	50
600mm	600	400	32	75	50
900mm	900	600	32	75	50

Stock Code	Size	Packing	Weight
GSL 224-450	450 mm	4 pcs/ctn	5 kgs
GSL 224-600	600 mm	4 pcs/ctn	5.5 kgs
GSL 224-900	900 mm	4 pcs/ctn	6 kgs



Model

## GSL 239

Pull Handle

Diagram

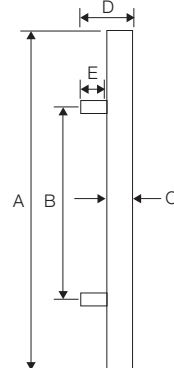

**Material**

SUS 304 Stainless Steel

**Finishing**

- M26D** - Satin Chrome ●
- M10B** - Matt Black ●
- M3M** - Satin Gold ●

Size	A	B	C	D	E
450mm	450	280	32	75	50
600mm	600	400	32	75	50
900mm	900	600	38	85	50
1200mm	1200	800	38	85	50
1500mm	1500	1200	45	90	50
1800mm	1800	1500	45	90	50

Stock Code	Size	Packing	Weight
GSL 239-450	450 mm	10 pcs/ctn	12.5 kgs
GSL 239-600	600 mm	4 pcs/ctn	6 kgs
GSL 239-900	900 mm	4 pcs/ctn	9.5 kgs
GSL 239-1200	1200 mm	4 pcs/ctn	12 kgs
GSL 239-1500	1500 mm	2 pcs/ctn	7 kgs
GSL 239-1800	1800 mm	1 pc/ctn	6 kgs



Model

## GH 4322 B

304 Stainless Steel Hinges with Bearing

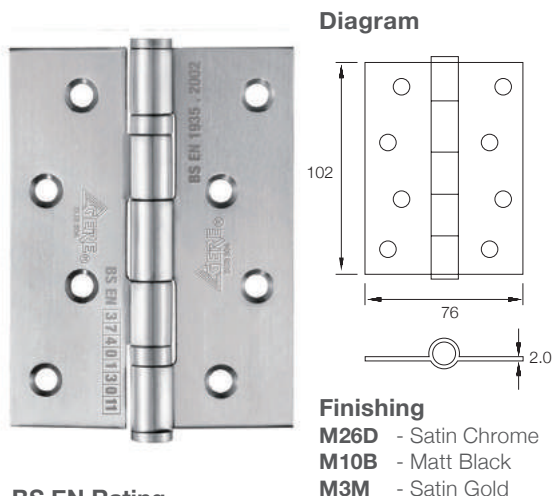

**Finishing**  
**M26D** - Satin Chrome ●  
**M10B** - Matt Black ●  
**M3M** - Satin Gold ●

**BS EN Rating**

3	7	4	0	1	3	0	11
---	---	---	---	---	---	---	----

Stock Code	Size	Packing	Weight
GH 4322B	4"x3"x2.0mm	100 pcs	17 kgs



**BS EN 1935 : 2002**  
 Passed durability test  
 200,000 cycles.

Model

## GH 5353 BB

304 Stainless Steel Hinges with Bearing

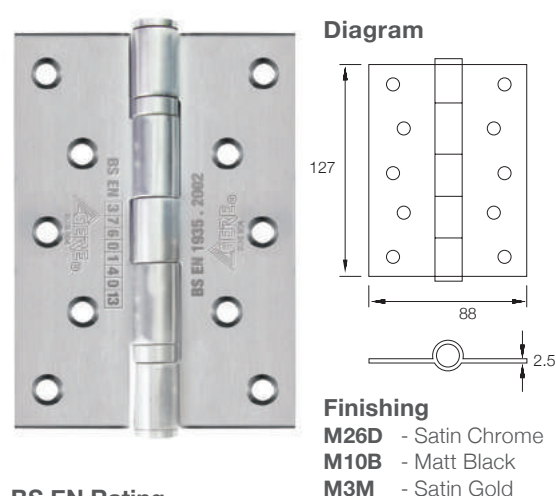

**Finishing**  
**M26D** - Satin Chrome ●  
**M10B** - Matt Black ●  
**M3M** - Satin Gold ●

**BS EN Rating**

3	7	6	0	1	4	0	13
---	---	---	---	---	---	---	----

Stock Code	Size	Packing	Weight
GH 5353BB	5"x3.5"x2.5mm	60 pcs	24 kgs



**BS EN 1935 : 2002**  
 Passed durability test  
 200,000 cycles.

Model

## GH 4322

304 Stainless Steel Hinges

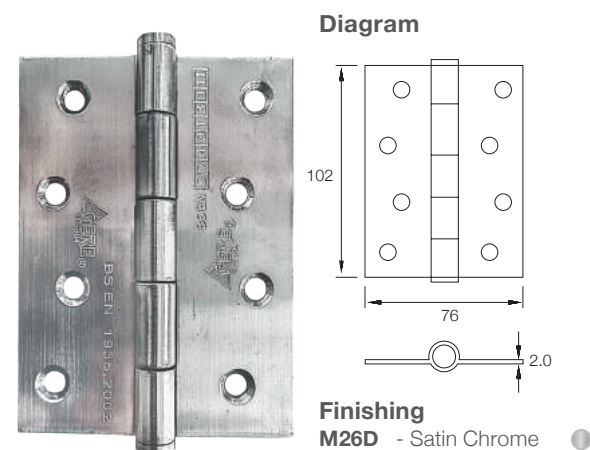

**Finishing**  
**M26D** - Satin Chrome ●

**BS EN Rating**

3	7	4	0	1	3	0	11
---	---	---	---	---	---	---	----

Stock Code	Size	Packing	Weight
GH 4322	4"x3"x2.0mm	100pcs	17 kgs



**BS EN 1935 : 2002**  
 Passed durability test  
 200,000 cycles.

Model

## GH 5353 BB

304 Stainless Steel Hinges with Bearing

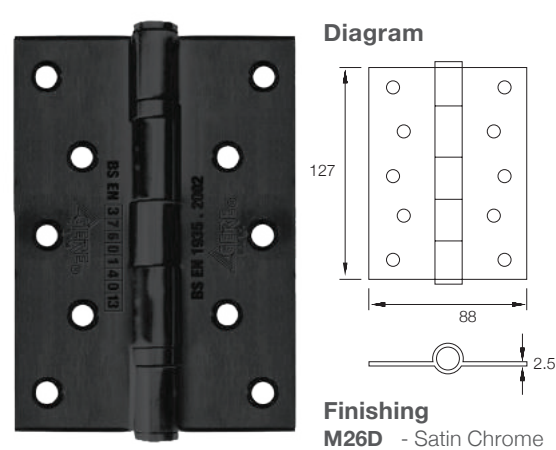

**Finishing**  
**M26D** - Satin Chrome ●  
**M10B** - Matt Black ●  
**M3M** - Satin Gold ●

**BS EN Rating**

3	7	6	0	1	4	0	13
---	---	---	---	---	---	---	----

Stock Code	Size	Packing	Weight
GH 5353BB	5"x3.5"x2.5mm	60 pcs	24 kgs



**BS EN 1935 : 2002**  
 Passed durability test  
 200,000 cycles.

# Flush Bolt



## Model GFB

SUS 304 Stainless Steel Flush Bolt

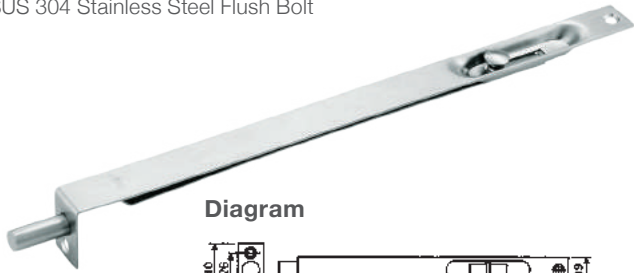

Diagram

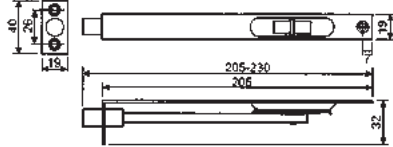

### Finishing

M26D - Satin Chrome ●

Stock Code	Size	Packing	Weight
GFB 6	150 mm	96 pcs	10.5 kgs
GFB 8	200 mm	120 pcs	12 kgs
GFB 10	250 mm	120 pcs	15 kgs
GFB 12	300 mm	96 pcs	15 kgs



## Model GFB 2

SUS 304 Stainless Steel Flush Bolt (Square Type)

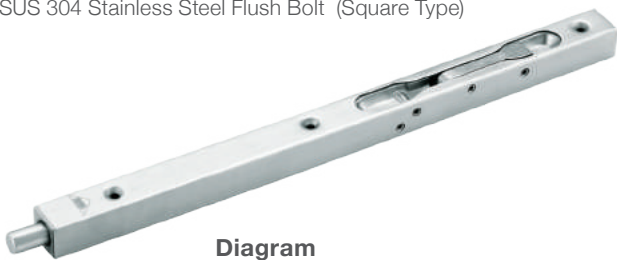

Diagram

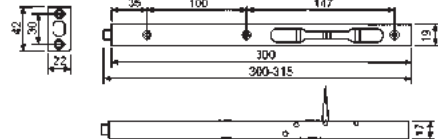

### Finishing

M26D - Satin Chrome ●  
 M11 - Antique Copper ●  
 M10B - Matt Black ●  
 M3M - Satin Gold ●

Stock Code	Size	Packing	Weight
GFB 2-6	150 mm	96 pcs	12 kgs
GFB 2-8	200 mm	96 pcs	13.9 kgs
GFB 2-10	250 mm	96 pcs	15.6 kgs
GFB 2-12	300 mm	96 pcs	15 kgs
GFB 2-18	450 mm	50 pcs	15.6 kgs
GFB 2-24	600 mm	72 pcs	29 kgs



## Model GFB 3 Auto

Auto Bolt  
SUS 304 Stainless Steel

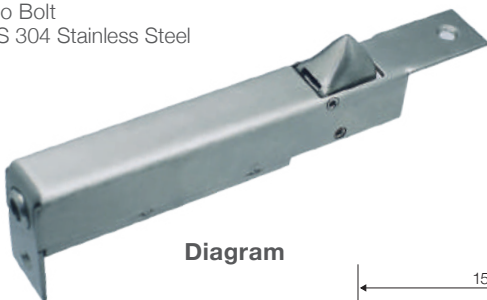

Diagram

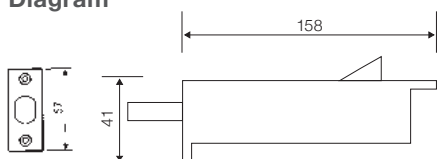

### Finishing

M26D - Satin Chrome ●

Stock Code	Size	Packing	Weight
GFB 3-Auto	158 mm	50 pcs	14 kgs



CERTIFIED TO: BS EN 12051.2000  
 Certification No: PC001792



BS EN 12051 . 2000  
 Passed durability test  
 50,000 cycles.





# Sliding Door Track

Model  
**GDT-600**

Sliding Door Track (Aluminium)

### Installation Instruction

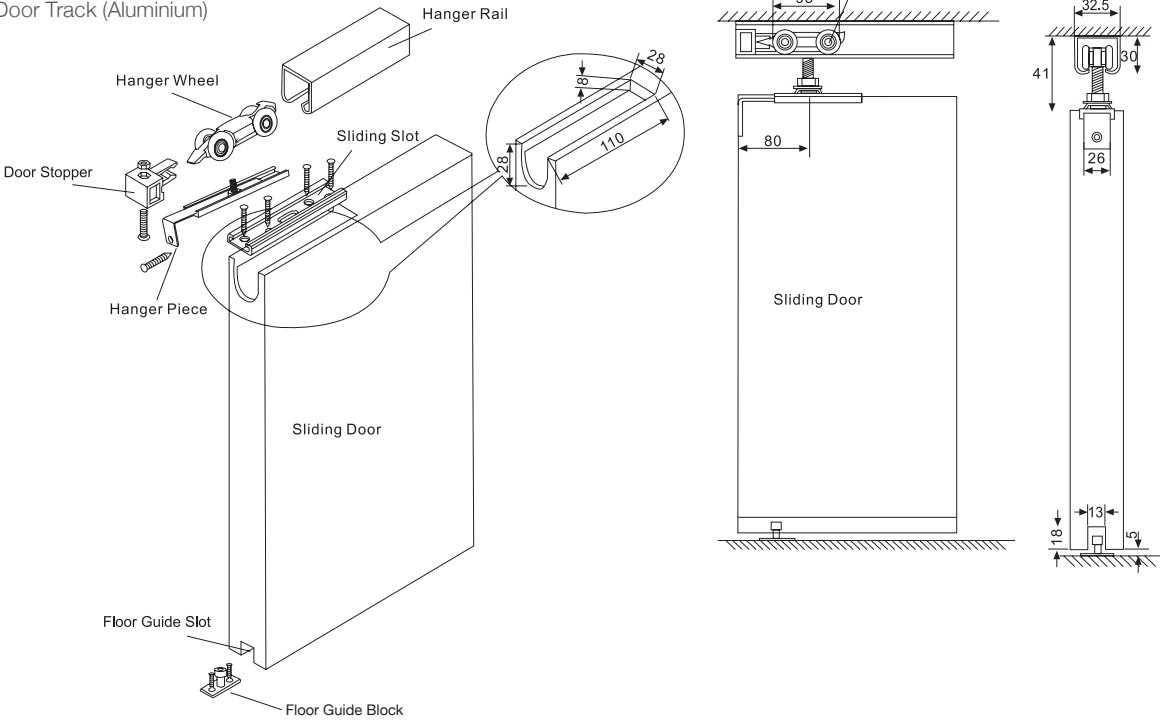

Model  
**GBD 2009**

Barn Door Sliding Track (Steel)



# Sliding Door Track

Model  
**GDT-600**  
Sliding Door Track (Aluminium)



Model  
**F-8009**  
Brackets Sliding Rail Fitting



Stock Code	Size
GDT-600 2m	<b>2.0 m</b>
GDT-600 3m	<b>3.0 m</b>
GDT-600 4m	<b>4.0 m</b>
GDT-600 T	<b>6.1 m</b>

Model  
**GDT 608**  
Heavy Duty Hanging Wheel

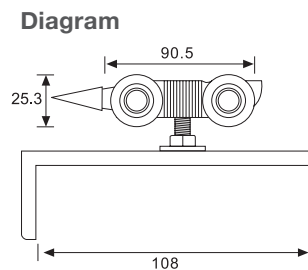

Stock Code	Size
GDT-608	<b>90.5 m</b>

	Track Thickness : 2.5mm
	Finish: Nickel brushed
	Materials: Zinc alloy + stainless steel
	<b>Max door weight: 120kg</b>
	Available for: All kinds of wooden sliding doors
	Function: Sliding door

Model  
**GBD 2009**  
Barn Door Sliding Track (Steel)



Stock Code	Size
GBD 2009-1.6	<b>1.6 m</b>
GBD 2009-1.8	<b>1.8 m</b>
GBD 2009-2.0	<b>2.0 m</b>
GBD 2009-2.4	<b>2.4 m</b>
GBD 2009-3.0	<b>3.0 m</b>



Model

## GDB 009

SUS 304 Stainless Steel Bolt

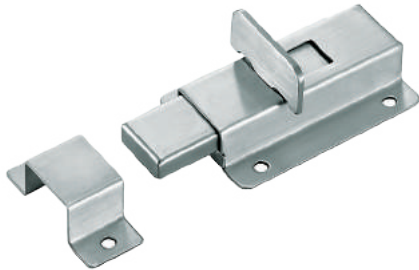

Diagram

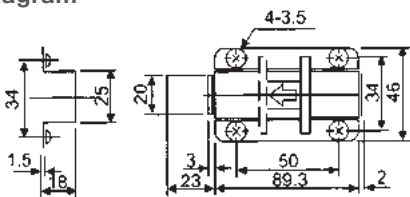

Finishing

M26D - Satin Chrome ●

Stock Code	Size	Packing	Weight
GDB 009	76 mm	100 pcs	10.5 kgs



Model

## GIB 001

SUS 304 Privacy Lock with Indicator

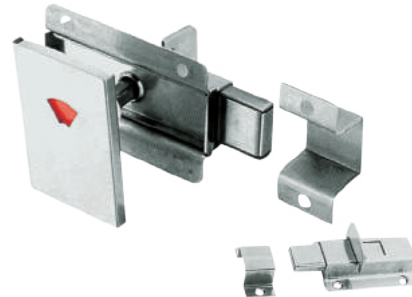

Diagram

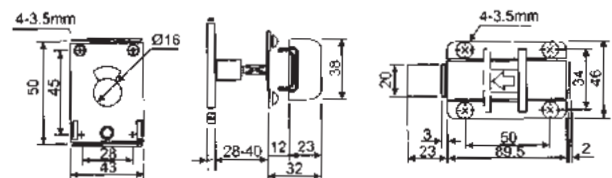

Finishing

M26D - Satin Chrome ●

Stock Code	Size	Packing	Weight
GIB 001	75 mm	100 pcs	9.8 kgs



Model

## GRP 28

Solid Brass Cylinder Lock Rebated Part



Diagram

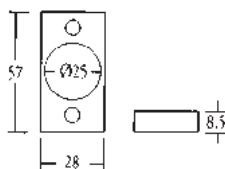

Finishing

M26D - Satin Chrome ●

Stock Code	Size	Packing	Weight
GRP 28	57 mm	500 pcs	22 kgs



Model

## GRPP 30

Cylinder Lock Rebated Part



Diagram

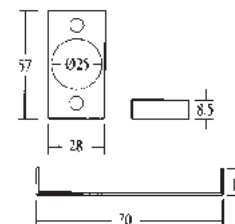

Finishing

M26D - Satin Chrome ●

Stock Code	Size	Packing	Weight
GRPP 30	57 mm	1000 pcs	22 kgs





# Accessories



Model

## GRP 168

Mortise Lock Rebated Part  
SUS 304 Stainless Steel

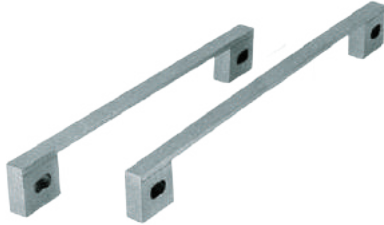

Diagram

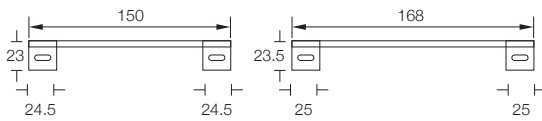

Finishing

M26D - Satin Chrome ●

Stock Code	Size	Packing	Weight
GRP 150	150 mm	200 pcs	20 kgs
GRP 168	168 mm	200 pcs	20.5 kgs



Model

## GRPP 170

Mortise Lock Rebated Part  
SUS 304 Stainless Steel



Diagram

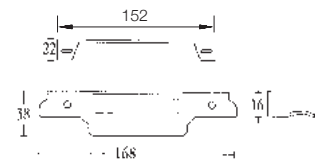

Finishing

M26D - Satin Chrome ●

Stock Code	Size	Packing	Weight
GRPP 170	168 mm	500 pcs	22 kgs



Model

## GRP 240

Mortise Lock Rebated Part  
SUS 304 Stainless Steel

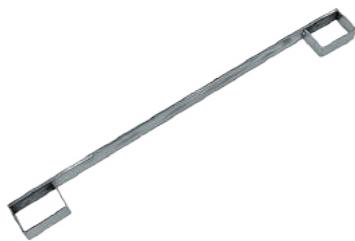

Diagram

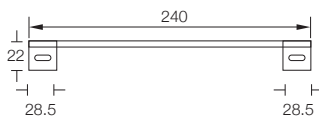

Finishing

M26D - Satin Chrome ●

Stock Code	Size	Packing	Weight
GRP 240	240 mm	200 pcs	23.1 kgs



Model

## GRPP 240

Mortise Lock Strike Plate  
SUS 304 Stainless Steel

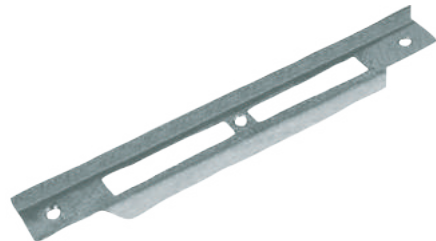

Diagram

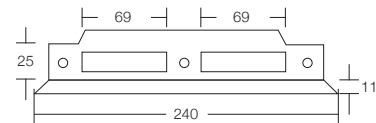

Finishing

M26D - Satin Chrome ●

Stock Code	Size	Packing	Weight
GRPP 240	240 mm	300 pcs	18.4 kgs



Model

## GTT 134

Privacy Lock with Thumb Turn Indicator  
SUS 304 Stainless Steel



Diagram

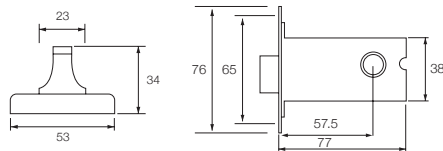

Finishing

M26D - Satin Chrome ●

Stock Code	Size	Packing	Weight
GTT 134	53 mm	40 pcs	16.3 kgs



Model

## GDT 006

Indicator Knob  
SUS 304 Stainless Steel



Diagram

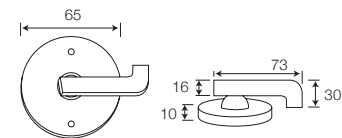

Finishing

M26D - Satin Chrome ●

Stock Code	Size	Packing	Weight
GDT 006	65 mm	40 pcs	16.3 kgs



Model

## G CH001

Recessed Cup Handle with Latch  
SUS 304 Stainless Steel

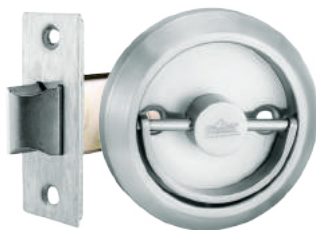

Diagram

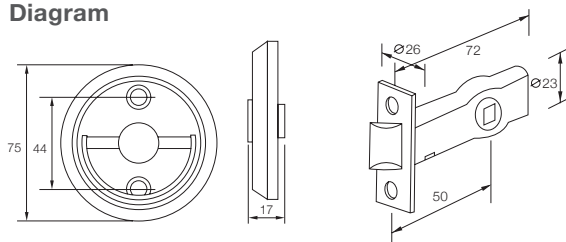

Finishing

M26D - Satin Chrome ●

Stock Code	Size	Packing	Weight
G CH001	75 mm	100 pcs	10.5 kgs



Model

## G CH002

Recessed Cup Handle  
SUS 304 Stainless Steel



Diagram

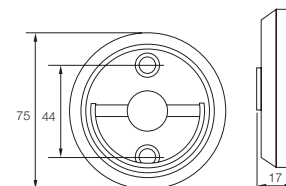

Finishing

M26D - Satin Chrome ●

Stock Code	Size	Packing	Weight
G CH002	75 mm	100 pcs	9.8 kgs





Model  
**GDS 003**  
Dust Socket



Diagram

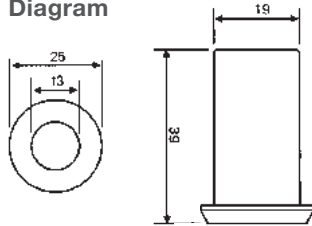

**Finishing**  
M26D - Satin Chrome ●  
M10B - Matt Black ●

Stock Code	Size	Packing	Weight
GDS 003	39 mm	120 pcs	10 kgs



Model  
**GL 60/70mm**  
Adjustable Latch

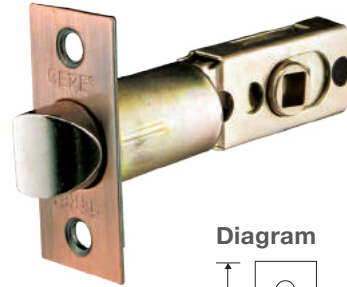

Diagram

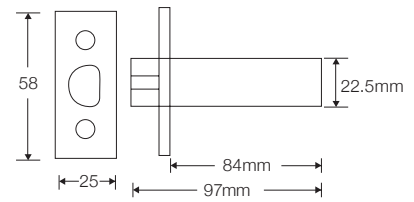

**Finishing**  
M26D - Satin Chrome ●

Stock Code	Size	Packing	Weight
GL 60/70	97 mm	300 pcs	26 kgs



Model  
**GDV 180**  
Solid Brass Door Viewer



Diagram

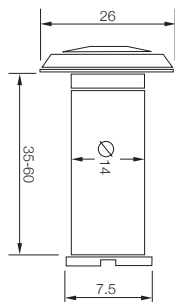

**Finishing**  
M26D - Satin Chrome ●  
M10B - Matt Black ●

Stock Code	Size	Packing	Weight
GDV 180	35 mm	120 pcs	8.5 kgs



Model  
**GLA 60/70mm**  
Solid Brass Adjustable Dead Bolt

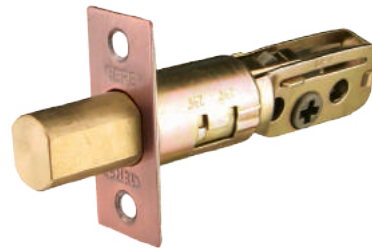

Diagram

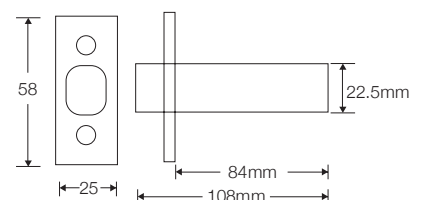

**Finishing**  
M26D - Satin Chrome ●

Stock Code	Size	Packing	Weight
GLA 60/70	108 mm	300 pcs	26 kgs





## Model GBC

Brass Ball Catch

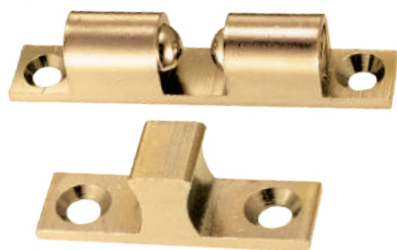

### Diagram

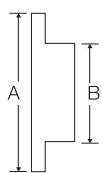

### Finishing

M3 - Polished Brass ●



Stock Code	Size (MM)	A	B	Packing	Weight (KG)
GBC 50	50	50	28	1000	27
GBC 60	60	60	31	500	26
GBC 70	70	70	41	500	28

## Model GBS

Cylindrical Latch

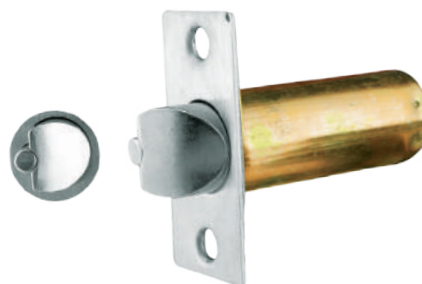

### Diagram

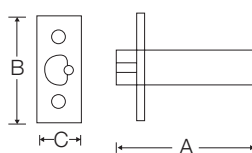

### Finishing

M26D - Satin Chrome ●



Stock Code	Size (MM)	A	B	C	Packing	Weight (KG)
GBS 60	60	50	58	25	600	36
GBS 60 (SUS304)	60	50	58	25	600	39
GBS 70	70	60	58	25	600	38
GBS 80	80	70	58	25	300	21
GBS 90	90	80	58	25	300	23
GEBS 60	60	50	58	25	600	34
GEBS 70	70	60	58	25	600	36

## Model Dummy Cover



### Diagram

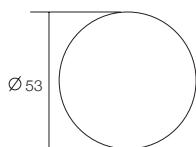

### Finishing

M26D - Satin Chrome ●  
M11 - Antique Copper ●  
M5 - Antique Brass ●

Stock Code	Size (MM)	Packing	Weight (KG)
Dummy Plate	53	80	7



## Model Cylinder

Handle Set / Deadbolt



### Diagram

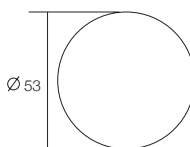

### Finishing

M26D - Satin Chrome ●  
M11 - Antique Copper ●  
M5 - Antique Brass ●

Stock Code	Size (MM)	Packing	Weight (KG)
Cylinder	53	80	10.6



# Accessories

## Model SBSS

Swing Bolt  
SUS 304 Stainless Steel

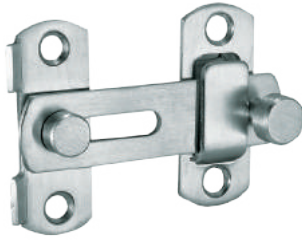

**Finishing**  
M26D - Satin Chrome ●

### Diagram

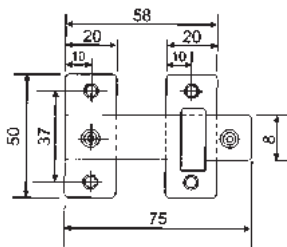

Stock Code	Size	Packing	Weight
SBSS	75 mm	100 pcs	6 kgs



## Model GDG 16

Door Guard

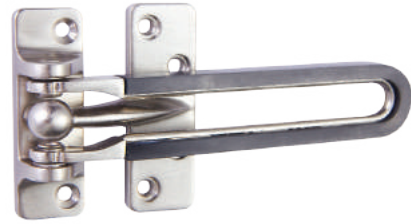

**Finishing**  
M26D - Satin Chrome ●  
M11 - Antique Copper ●  
M10B - Matt Black ●

### Diagram

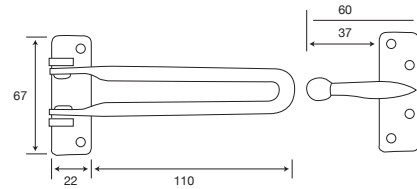

Stock Code	Size	Packing	Weight
GDG 16	132 mm	100 pcs	22.5 kgs



## Model GDG 909

Door Guard



**Finishing**  
M26D - Satin Chrome ●  
M11 - Antique Copper ●  
M10B - Matt Black ●

### Diagram

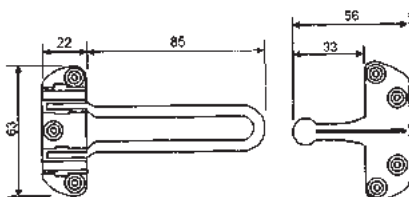

Stock Code	Size	Packing	Weight
GDG 909	107 mm	100 pcs	22.5 kgs



## Model GDC 715

Door Bolt & Chain



**Finishing**  
M26D - Satin Chrome ●  
M11 - Antique Copper ●

### Diagram

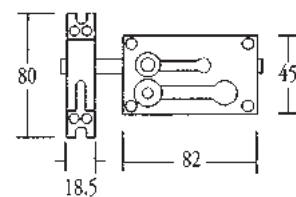

Stock Code	Size	Packing	Weight
GDC 715	82 mm	36 pcs	12 kgs



Model

## GDGC 1100

Door Guard  
SUS 304 Stainless Steel



### Finishing

- M26D - Satin Chrome
- M10B - Matt Black

### Diagram

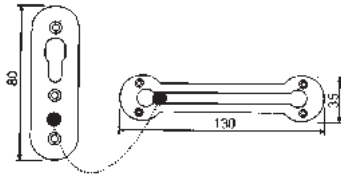

Stock Code	Size	Packing	Weight
GDGC 1100	130 mm	48 pcs	10 kgs



Model

## GDS 020

Door Stopper  
SUS 304 Stainless Steel



### Finishing

- M26D - Satin Chrome
- M10B - Matt Black

### Diagram

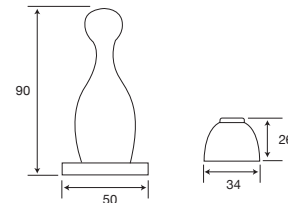

Stock Code	Size	Packing	Weight
GDS 020	90 mm	100 pcs	25.6 kgs



Model

## GDH

Solid Brass Magnetic Door Holder



### Finishing

- M26D - Satin Chrome
- M11 - Antique Copper
- M10B - Matt Black

### Diagram

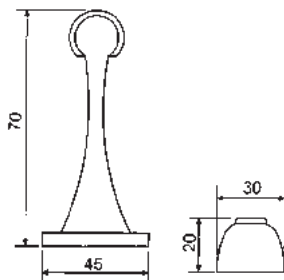

Stock Code	Size	Packing	Weight
GDH	70 mm	80 pcs	15 kgs



Model

## GDH 008

Magnetic Door Holder



### Finishing

- M26D - Satin Chrome
- M10B - Matt Black

### Diagram

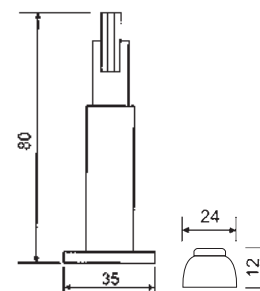

Stock Code	Size	Packing	Weight
GDH 008	96 mm	48 pcs	12 kgs





# Accessories



Model  
**GDS 046 (R/L)**

Door Stopper  
SUS 304 Stainless Steel



**Finishing**

**M26D** - Satin Chrome ●

**Diagram**

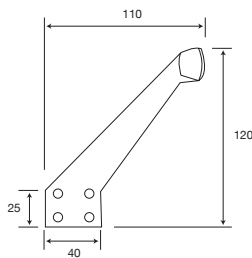

Stock Code	Size	Packing	Weight
GDS 046	120 mm	100 pcs	10.7 kgs



Model  
**DH 002**

Dome Door Stopper



**Finishing**

**M26D** - Satin Chrome ●  
**M11** - Antique Copper ●  
**M10B** - Matt Black ●

**Diagram**

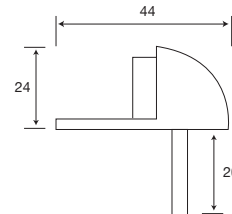

Stock Code	Size	Packing	Weight
DH 002	44 mm	100 pcs	9 kgs



Model  
**GDH 05**

Door Stopper  
SUS 304 Stainless Steel



**Finishing**

**M26D** - Satin Chrome ●

**Diagram**

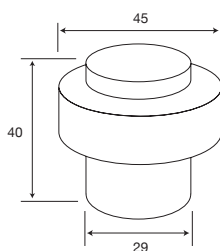

Stock Code	Size	Packing	Weight
GDH 05	45 mm	40 pcs	14 kgs



Model  
**DH 011**

Door Stopper with Rubber



**Finishing**

**M26D** - Satin Chrome ●  
**M11** - Antique Copper ●

**Diagram**

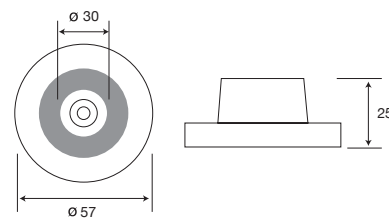

Stock Code	Size	Packing	Weight
DH 011	57 mm	200 pcs	16 kgs



Model

## GDH 16

Door Stopper  
SUS 304 Stainless Steel



### Finishing

M26D - Satin Chrome

### Diagram

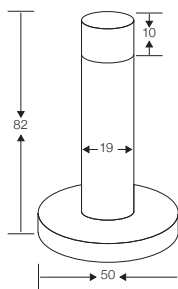

Stock Code	Size	Packing	Weight
GDH 16	82 mm	50 pcs	7 kgs



Model

## GDH 07

Door Stopper with Hook  
SUS 304 Stainless Steel



### Finishing

M26D - Satin Chrome

### Diagram

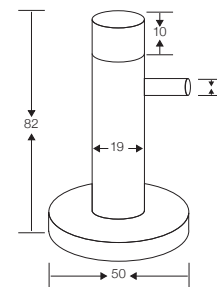

Stock Code	Size	Packing	Weight
GDH 07	82 mm	50 pcs	7 kgs



Model

## GDH 023

Door Stopper  
SUS 304 Stainless Steel



### Finishing

M26D - Satin Chrome

### Diagram

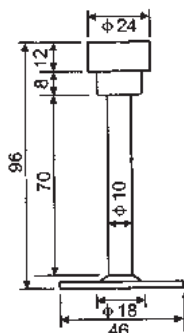

Stock Code	Size	Packing	Weight
GDH 023	96 mm	100 pcs	12.6 kgs



Model

## GDH 024

Door Stopper / Hat / Coat hook  
SUS 304 Stainless Steel



### Finishing

M26D - Satin Chrome

### Diagram

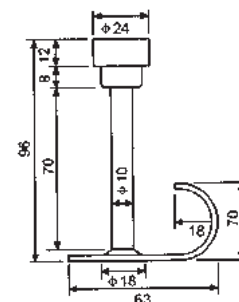

Stock Code	Size	Packing	Weight
GDH 024	96 mm	100 pcs	13.8 kgs



# Accessories



Model

## GDS 044

Clothes Hook  
SUS 304 Stainless Steel



### Finishing

M26D - Satin Chrome ●

### Diagram

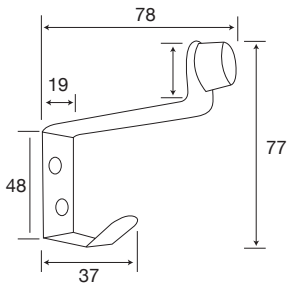

Stock Code	Size	Packing	Weight
GDS 044	78 mm	200 pcs	19.4 kgs



Model

## GDS 045

Clothes Hook  
SUS 304 Stainless Steel



### Finishing

M26D - Satin Chrome ●

### Diagram

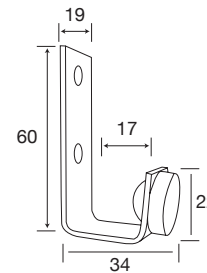

Stock Code	Size	Packing	Weight
GDS 045	34 mm	300 pcs	16.7 kgs



Model

## GE 001

Round Escutcheon  
SUS 304 Stainless Steel



### Finishing

M26D - Satin Chrome ●

### Diagram

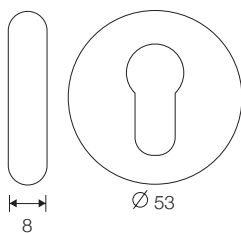

Stock Code	Size	Packing	Weight
GE 001	53 mm	200 pcs	19 kgs



Model

## GE 006

Oval Escutcheon  
SUS 304 Stainless Steel



### Finishing

M26D - Satin Chrome ●

### Diagram

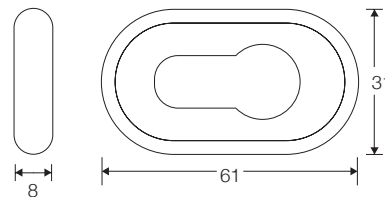

Stock Code	Size	Packing	Weight
GE 006	61 mm	200 pcs	16 kgs





Model

## G FH0030

Oval Furniture Handle  
SUS 304 Stainless Steel



### Finishing

**M26D** - Satin Chrome

### Diagram

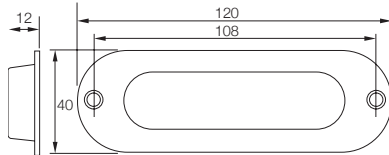

Stock Code	Size	Packing	Weight
G FH0030	96 mm	60 pairs	10 kgs



Model

## G FH0040

Furniture Handle  
SUS 304 Stainless Steel



### Finishing

**M26D** - Satin Chrome

### Diagram

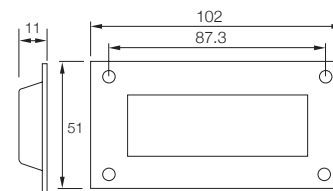

Stock Code	Size	Packing	Weight
G FH0040	102 mm	20 pairs	3.6 kgs



Model

## G FH0020

Circle Furniture Handle  
SUS 304 Stainless Steel



### Finishing

**M26D** - Satin Chrome

### Diagram

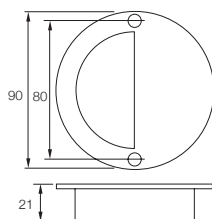

Stock Code	Size	Packing	Weight
G FH0020	90 mm	20 pcs	2.7 kgs



Model

## GCH 010

Cup Handle  
SUS 304 Stainless Steel



### Finishing

**M26D** - Satin Chrome

### Diagram

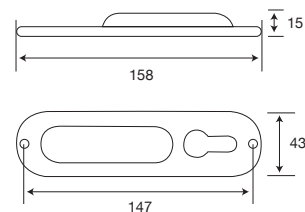

Stock Code	Size	Packing	Weight
GCH 010	158 mm	50 pairs	9 kgs



# Accessories

Model

## GSB 001

Security Bolt  
SUS 304 Stainless Steel

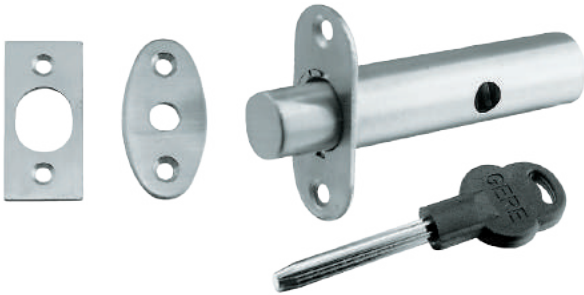

**Finishing**

M26D - Satin Chrome ●

**Diagram**

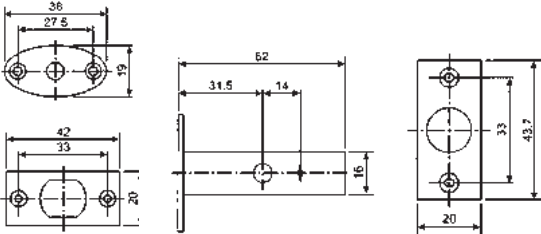

Stock Code	Size	Packing	Weight
GSB 001	62 mm	100 pcs	10.5 kgs



Model

## GRL 005

Roller Latch 304  
SUS 304 Stainless Steel



**Finishing**

M26D - Satin Chrome ●

**Diagram**

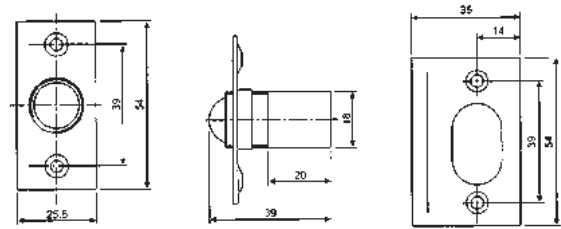

Stock Code	Size	Packing	Weight
GRL 005	30 mm	100 pcs	10 kgs



Model

## GRS-25

Transparent Silicone Rubber Stopper



**Diagram**

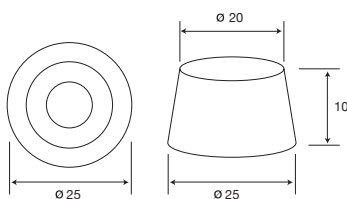

Stock Code	Size	Packing	Weight
GRS-25	25 mm	500 pcs	2 kgs

Model

## G 06

Hook Lock With Cup Handle



**Diagram**

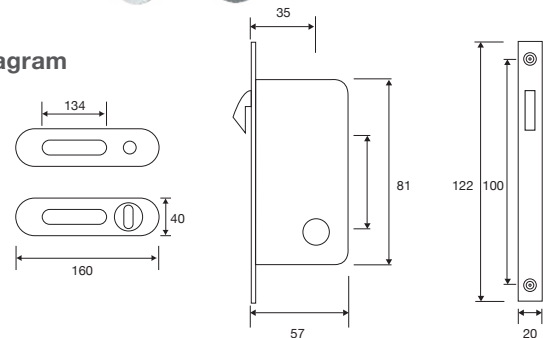

Stock Code	Size	Packing	Weight
G 06	35 mm	30 pcs	17.4 kgs

**Briton<sup>®</sup>**



**Briton<sup>™</sup> Installation**

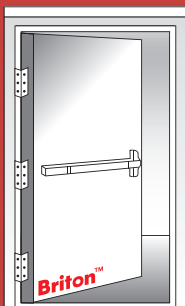

RIM

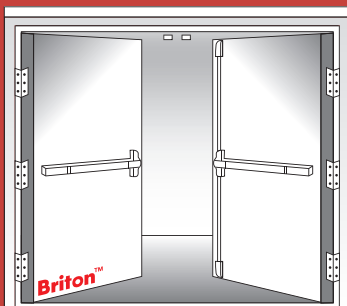

RIM

VERTICAL

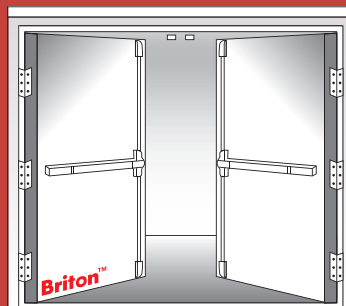

VERTICAL

VERTICAL

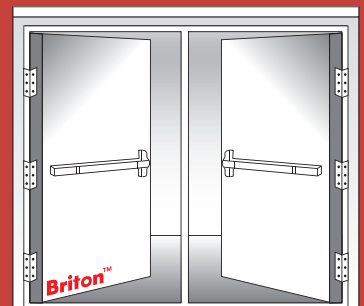

RIM

RIM

**600 Series  
Exit Device**

As the leading manufacturer of exit device, IR released its new Briton 600 series exit devices. With the concept of excellent design and customer oriented service, Briton 600 exit devices provide you trustworthy performance and comfortable user experience with unique design and strict quality control system.

The product can be used in most applications, such as on fire doors, non-fire doors, wood doors, metal doors, inside doors, outside doors, and etc.

The product is certified by independent third-party test lab according to EN 1125, and passed 1.5h fire modality test according to standard GB 12955-2008.





Model

## RIM Exit Device



Model

## Vertical Exit Device



**Diagram**  
**RIM Exit Device**

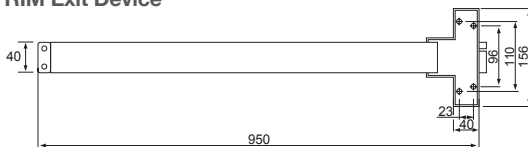

**Diagram**  
**Vertical Exit Device**

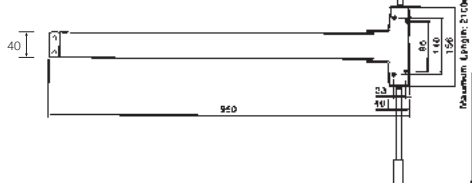

- Device length : 950mm
- Maximum door weight: 150kg
- Maximum door height: 2400mm
- Maximum gate width: 1000mm
- Installation height from centre line of the exit device to the ground: 905mm-1260mm
- Minimum door width 720mm

### Features

- Silver coating, anti-corrosion, streamlined design, with protective Neato on the surface
- Pushpad with roller made in brass to reduce friction
- Machine Screws for metal door

**Features**  
**RIM Exit Device**

- Patent-pending Inter - Link mechanism for easy work and longer cycle life
- Two piece Latchbolt made in high quality power coating to ensure high security
- Roller strike for easy work and impact resistance
- Self Tapping Screw for wood door
- Lever-Modern design, pass the tough requirement of EN12209 Grade 1. Suitable for door thickness: 40mm-60mm

**Features**  
**Vertical Exit Device**

- Top latch made in SUS304 to deliver greater strength and impact resistance
- Bottom latch with dustproof for easy cleaning and maintenance
- Patent-pending transmission mechanism for easy installation
- Lever- Modern design, pass the tough requirement of EN12209 Grade 1. Suitable for door thickness: 40mm-60mm
- Screws-Self Tapping Screws for wood door
- Lever with high security
- Available 8 feet

Model  
**G-DK1110**  
 RIM Exit Device



**Diagram**

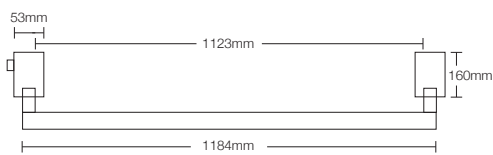

**Specification**

- Door thickness: 32mm - 50mm
- Material: Zamak3

**Finishing**

**M26D** - Satin Chrome ●

Model  
**G-011LE**  
 Panic Device Door Handle



**Diagram**

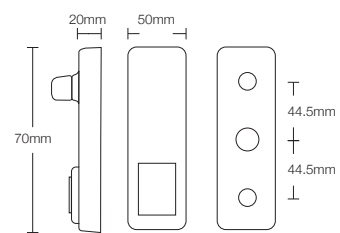

**Specification**

- Door thickness: 38mm - 70mm
- Material: Zamak3

**Finishing**

**M26D** - Satin Chrome ●

Model  
**G-MS70**  
 Electro Magnetic EM Door Holder



**Diagram**

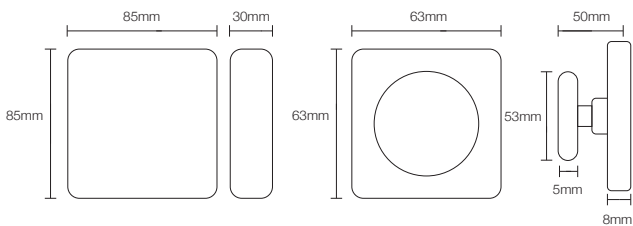

# Cylindrical Lock



Model  
**G 8871**

**EUROPLUS**

Model  
**P 5791**

**Propilot**



Brass Cylinder



Brass Cylinder



**Diagram**



Size	A	B
G 8871	54	75
P 5791	55	75

Model  
**P 82070**  
P 82071



Brass Cylinder



Model  
**P 82080**  
P 82081



Brass Cylinder

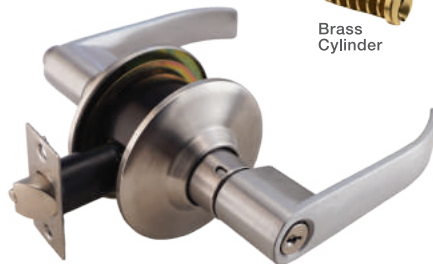

**Diagram**

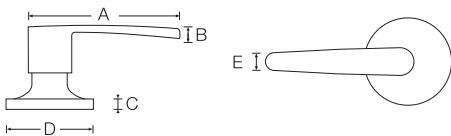

Size	A	B	C	D	E
P 82070	120	7	5	75	10
P 82080	107	4	5	75	20

**Specification**

- Standard backset 60mm
- Suitable door thickness 30mm - 45mm
- 3 Steel key
- Brass cylinder
- Stainless steel knob
- Aluminium lever handle

**Finishing**

- M11** - Antique Copper
- M26D** - Satin Chrome

**Function**

- Entrance
- Privacy\*

\* exclusively for europlus knob only

Stock Code	Packing	Weight (KG)
G 8871	30	17
G 8872	30	17
P-5791	24	19,6
P-82071	24	18
P-82081	24	18



Model  
**P-51**



**Diagram**

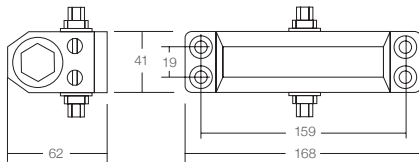

**Specification**

- Standard arm and parallel bracket included
- Max door weight 30kgs
- Suitable for plywood flush door
- Light duty usage

Packing - Box pack

Stock Code	Packing	Weights
P-51	10 pcs	12.5 kgs

Model  
**GH 432**



**Specification**

- Material - Stainless Steel
- Supplied with 8 pcs steel screws
- Light duty usage

**Finishing**

**M26D** - Satin Chrome

**Diagram**

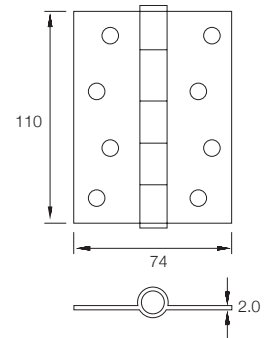

Packing - Box pack

Stock Code	Packing	Weights
GH 432	144 pairs	53 kgs

Model



Chromed Steel Padlock

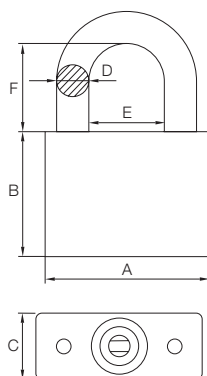
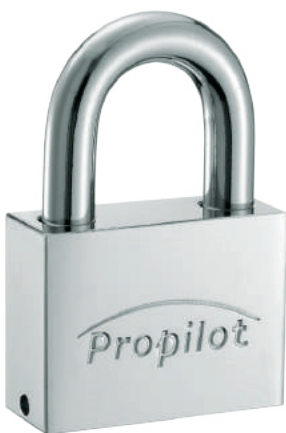

**Specification**

- Hardened steel shackle
- Solid chromed steel body
- Zamak 3 Zinc-Alloy-Cylinder
- 4 Chromed steel keys
- Key-Retaining function
- Keyed-Alike up to 1000 pcs/sets is available upon request
- Double blister pack for single padlock
- Skin packed for Keyed-Alike set & master set

Stock Code	Size	Packing	Weight
PCL 401	40 mm	48 pcs	14 kgs
PCL 501	50 mm	48 pcs	19 kgs

Size	A	B	C	D	E	F
40mm	40	32	20	7.4/7.2	20/19.8	22
50mm	50	38	20	10/9.8	23/23.2	29



# Key Blank



Model  
**GKB 1-02**  
Key Blank



Diagram

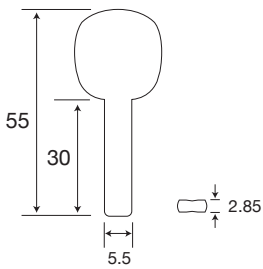

Stock Code	Size	Packing	Weight
GKB 1-02	55 mm	1000 pcs	17.5 kgs

Model  
**GKB 1-03**  
Key Blank



Diagram

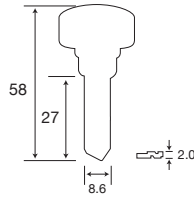

Stock Code	Size	Packing	Weight
GKB 1-03	58 mm	1000 pcs	11 kgs

Model  
**GSBKB-001**  
Key Blank



Diagram

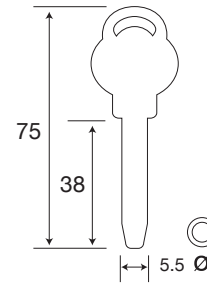

Stock Code	Size	Packing	Weight
GSBKB-001	75 mm	1000 pcs	20 kgs

Model  
**GKB 05**  
Key Blank



Diagram

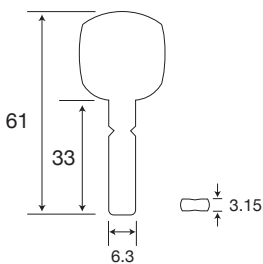

Stock Code	Size	Packing	Weight
GKB 05	61 mm	1000 pcs	17.5 kgs

Model  
**GKB 06**  
Key Blank



Diagram

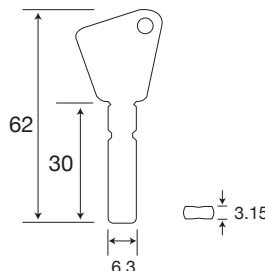

Stock Code	Size	Packing	Weight
GKB 06	62 mm	1000 pcs	17.5 kgs

Model  
**CL54 KB**  
Key Blank



Diagram

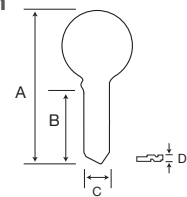

Size mm	A	B	C	D
CL 5404 KB	36	15	5.2	1.4
CL 5401 KB	41	18	6.5	1.7
CL 5402 KB	47	21	6.6	1.7
CL 5403 KB	52	23	8.0	1.8

Stock Code	Size	Packing	Weight
CL 5404 KB	36 mm	1000 pcs	8 kgs
CL 5401 KB	41 mm	1000 pcs	9 kgs
CL 5402 KB	47 mm	1000 pcs	10.5 kgs
CL 5403 KB	52 mm	1000 pcs	12 kgs

At Gere, our security products are built tough, aim to protect your home and belongings seamlessly, each masterpiece are designed with intelligence, crafted for endurance and known for it's reliability. We are your lifelong RELIABLE guardian of safety.



**HIGH RESERVE MARKETING SDN. BHD.** (106032-T)

No. 2 & 4, Jalan BK 1/19, Kinrara Industrial Park,  
Bandar Kinrara, 47100 Puchong, Selangor D.E. Malaysia.

Tel: +603 8076 1833 Fax: +603 8076 1822

Web: [www.gere-products.com](http://www.gere-products.com)

Email: [service@highreserve.com](mailto:service@highreserve.com)

Authorised Sole Distributor

**Briton®**



**SIRIM**  
CERTIFIED TO: ANSU/BHMA A 156.2



CERTIFIED TO ISO 9001:2015  
CERT. NO.: QMS 02919



CERTIFIED TO ISO 14001:2015  
CERT. NO.: EMS 00726